



Standard Specification for Wrought Carbon Steel Sleeve-Type Pipe Couplings¹

This standard is issued under the fixed designation F682; the number immediately following the designation indicates the year of original adoption or, in the case of revision, the year of last revision. A number in parentheses indicates the year of last reapproval. A superscript epsilon (ϵ) indicates an editorial change since the last revision or reapproval.

This standard has been approved for use by agencies of the U.S. Department of Defense.

1. Scope

1.1 This specification covers wrought carbon steel sleeve-type pipe couplings suitable for joining carbon steel pipes.

1.2 Type I couplings are intended for use on all schedules of pipe in which the pipe wall thickness does not exceed the wall thickness of standard weight pipe. Type II couplings are intended for use on all schedules of pipe in which the pipe wall thickness does not exceed the wall thickness of extra strong pipe.

1.3 This specification does not cover cast steel couplings.

NOTE 1—The values stated in inch-pound units are to be regarded as the standard.

NOTE 2—See ~~Appendix X1~~ for rationale used to develop this specification.

NOTE 2—See ~~Appendix X1~~ for rationale used to develop this specification.

2. Referenced Documents

2.1 *ASTM Standards:*²

[A53/A53M Specification for Pipe, Steel, Black and Hot-Dipped, Zinc-Coated, Welded and Seamless](#)

[A106/A106M Specification for Seamless Carbon Steel Pipe for High-Temperature Service](#)

[A234/A234M Specification for Piping Fittings of Wrought Carbon Steel and Alloy Steel for Moderate and High Temperature Service](#)

[A370 Test Methods and Definitions for Mechanical Testing of Steel Products](#)

[E59 Practice for Sampling Steel and Iron for Determination of Chemical Composition \(Withdrawn 1996\)](#)³

2.2 ~~Manufacturer's Standardization Society of the Valve and Fittings Industry Standard: [MMS Standards](#):~~⁴

~~[MSS SP-25 Standard Marking System for Valves, Fittings, Flanges, and Unions](#)~~

2.3 ~~ASME Boiler and Pressure Vessel Code: [Codes](#):~~⁵

~~[Section VIII Unfired Pressure Vessels](#)~~

~~[Section IX Welding Qualifications](#)~~

2.4 ~~Federal Regulations:~~⁶

~~[Title 46, 46 Code of Federal Regulations \(CFR\), Shipping, Parts 41 to 69](#)~~

2.5 ~~ANSI Standards:~~⁷

~~[B16.5 Pipe Flanges and Flange Fittings](#)~~

3. Classification

3.1 Couplings are furnished in two types as follows:

3.1.1 *Type I*—Couplings (see [1.2](#)).

3.1.2 *Type II*—Couplings (see [1.2](#)).

¹ This specification is under the jurisdiction of ASTM Committee F25 on Ships and Marine Technology and is the direct responsibility of Subcommittee F25.11 on Machinery and Piping Systems.

Current edition approved Nov. 1, 2008 Aug. 1, 2014. Published December 2008 September 2014. Originally approved in 1980. Last previous edition approved in 2004 2008 as F682 – 82a (2004) (2008). DOI: 10.1520/F0682-82AR08; 10.1520/F0682-82AR14.

² For referenced ASTM standards, visit the ASTM website, www.astm.org, or contact ASTM Customer Service at service@astm.org. For *Annual Book of ASTM Standards* volume information, refer to the standard's Document Summary page on the ASTM website.

³ The last approved version of this historical standard is referenced on www.astm.org.

⁴ Available from Manufacturers Standardization Society of the Valve and Fittings Industry (MSS), 127 Park St., NE, Vienna, VA 22180-4602, <http://www.mss-hq.org>.

⁵ Available from American Society of Mechanical Engineers (ASME), ASME International Headquarters, Two Park Ave., New York, NY 10016-5990, <http://www.asme.org>.

⁶ Available from Standardization Documents Order Desk, DODSSP, Bldg. 4, Section D, 700 Robbins Ave., Philadelphia, PA 19111-5098, <http://dodssp.daps.dla.mil>.

⁷ Available from American National Standards Institute (ANSI), 25 W. 43rd St., 4th Floor, New York, NY 10036, <http://www.ansi.org>.

NOTE 3—Type II couplings may be used in place of Type I couplings for all schedules of pipe in which the pipe wall thickness does not exceed the wall thickness of standard weight piping through 18 in. or Schedule 40 piping through 16 in.

4. Ordering Information

- 4.1 Orders for material under this specification shall include the following information:
- 4.1.1 Quantity (number of couplings of each size and type),
 - 4.1.2 Name of material (sleeve-type pipe couplings),
 - 4.1.3 Size (nominal, see [Table 1](#) and [Table 2](#) and [Fig. 1](#)),
 - 4.1.4 Type (see [3.1](#)),
 - 4.1.5 ASTM designation and date of issue.

5. Materials and Manufacture

5.1 *Materials*—The couplings shall be manufactured from material having a chemical composition conforming to the requirements of [7.1](#) and with the mechanical properties of [Section 9](#).

5.2 *Manufacture*—The initial form of the raw material shall be at the discretion of the manufacturer except couplings shall not be machined from unformed plate. The material shall be such that the finished couplings conform to all of the specified requirements (see [Appendix X2](#)).

5.3 Couplings fabricated by welding shall be (a) made by welders, welding operators, and welding procedures qualified under the provisions of ASME Boiler and Pressure Vessel Code, Section IX; (b) heat treated in accordance with [Section 6](#) of this specification; and (c) nondestructively tested as follows:

5.3.1 *Sizes 3-in. NPS and Below*—Radiographically examined throughout the entire length of each fabricated weld in accordance with Paragraph UW-51 of ASME Code, Section VIII.

5.3.2 *Sizes 3½-in. NPS Through 16-in. NPS*—No nondestructive tests required, and

5.3.3 *Sizes 18-in. NPS and Above*—Any method of nondestructive testing may be used provided the tests are conducted in accordance with the applicable parts of ASME Code, Section VIII.

6. Heat Treatment

6.1 *Couplings Made from Plate or Tubular Products*:

6.1.1 Couplings machined from tubular products need not be heat treated.

6.1.2 Hot-formed couplings upon which the final forming operation is completed at a temperature above 1150°F (621°C) and below 1800°F (982°C) need not be heat treated provided they are cooled in still air. If the manufacturer elects to heat treat such couplings it shall be by one of the procedures described in [6.3](#).

6.1.3 Hot-formed couplings finished at a temperature in excess of 1800°F (982°C) shall subsequently be annealed, normalized, or normalized and tempered.

TABLE 1 Dimensions for Type I Couplings (See [Fig. 1](#))

Nominal Size, in.	Dimension A, Inside Diameter, in. (mm) ^A	Dimension B, Outside Diameter, in. (mm) ^B	Dimension C, Thickness, min. in. (mm)	Dimension D, Length, in. (mm) ^C
¼	0.589 (15.0)	0.875 (22.2)	0.143 (3.6)	1 (25)
⅜	0.724 (18.4)	0.992 (25.2)	0.134 (3.4)	1¼ (32)
½	0.889 (22.6)	1.201 (30.5)	0.156 (4.0)	1¼ (32)
¾	1.099 (27.9)	1.401 (35.6)	0.151 (3.8)	1½ (38)
1	1.364 (34.6)	1.710 (43.4)	0.173 (4.4)	1½ (38)
1¼	1.709 (43.4)	2.057 (52.2)	0.174 (4.4)	1½ (38)
1½	1.949 (49.5)	2.306 (58.6)	0.179 (4.5)	1½ (38)
2	2.424 (61.6)	2.807 (71.3)	0.192 (4.9)	1½ (38)
2½	2.924 (74.3)	3.444 (87.5)	0.260 (6.6)	1½ (38)
3	3.545 (90.0)	4.105 (104.3)	0.280 (7.1)	1½ (38)
3½	4.070 (103.4)	4.633 (117.7)	0.282 (7.2)	2 (51)
4	4.570 (116.1)	5.164 (131.2)	0.297 (7.5)	2 (51)
5	5.660 (143.8)	6.286 (159.7)	0.313 (8.0)	2 (51)
6	6.720 (170.7)	7.409 (188.2)	0.345 (8.8)	2 (51)
8	8.720 (221.5)	9.527 (242.0)	0.404 (10.3)	2½ (64)
10	10.880 (276.4)	11.875 (301.6)	0.498 (12.6)	2½ (64)
12	12.880 (327.2)	13.800 (350.5)	0.460 (11.7)	2½ (64)
14	14.140 (359.2)	15.050 (382.3)	0.455 (11.6)	2½ (64)
16	16.160 (410.5)	17.050 (433.1)	0.445 (11.3)	2½ (64)
18	18.180 (461.8)	19.050 (483.9)	0.435 (11.0)	2½ (64)

^A Tolerances shall be (1) Sizes through 3 in. incl: +0.000, -0.010 in. (+0.000, -0.254 mm); (2) Sizes 3½ through 10 in. incl: +0.030, -0.000 in. (+0.762, -0.000 mm); and (3) Sizes above 10 in.: +0.060, -0.000 in. (+1.524, -0.000 mm).

^B Tolerances shall be (1) Sizes through 10 in. incl: +0.125, -0.000 in. (+3.175, -0.000 mm) and (2) Sizes above 10 in.: +1.000, -0.000 in. (+25.4, -0.000 mm).

^C Tolerances for all sizes shall be +0.250, -0.000 in. (+6.4, -0.000 mm).



TABLE 2 Dimensions for Type II Couplings (See Fig. 1)

Nominal Size, in.	Dimension A, Inside Diameter, in. (mm) ^A	Dimension B, Outside Diameter, in. (mm) ^B	Dimension C, Thickness, min. in. (mm)	Dimension D, Length, in. (mm)
1/4	0.589 (15.0)	1.055 (26.8)	0.233 (5.9)	1 (25)
3/8	0.724 (18.4)	1.156 (29.4)	0.216 (5.5)	1 1/4 (32)
1/2	0.889 (22.6)	1.369 (34.8)	0.240 (6.1)	1 1/4 (32)
3/4	1.099 (27.9)	1.557 (39.5)	0.229 (5.8)	1 1/2 (38)
1	1.364 (34.6)	1.876 (47.7) [†]	0.256 (6.5) [†]	1 1/2 (38)
1 1/4	1.364 (34.6)	1.876 (47.7)	0.256 (6.5)	1 1/2 (38)
1 1/2	1.709 (43.4)	2.221 (56.4) [†]	0.256 (6.5) [†]	1 1/2 (38)
2	1.709 (43.4)	2.221 (56.4)	0.256 (6.5)	1 1/2 (38)
2 1/2	1.949 (49.5)	2.469 (62.7) [†]	0.260 (6.6) [†]	1 1/2 (38)
3	1.949 (49.5)	2.469 (62.7)	0.260 (6.6)	1 1/2 (38)
3 1/2	2.424 (61.6)	2.986 (75.8) [†]	0.281 (7.1) [†]	1 1/2 (38)
4	2.424 (61.6)	2.986 (75.8)	0.281 (7.1)	1 1/2 (38)
4 1/2	2.924 (74.3)	3.648 (92.7) [†]	0.362 (9.2) [†]	1 1/2 (38)
5	2.924 (74.3)	3.648 (92.7)	0.362 (9.2)	1 1/2 (38)
5 1/2	3.545 (90.0)	4.340 (110.2) [†]	0.398 (10.1) [†]	1 1/2 (38)
6	3.545 (90.0)	4.340 (110.2)	0.398 (10.1)	1 1/2 (38)
6 1/2	4.070 (103.4)	4.891 (124.2) [†]	0.411 (10.4) [†]	2 (51)
7	4.070 (103.4)	4.891 (124.2)	0.411 (10.4)	2 (51)
7 1/2	4.570 (116.1)	5.444 (138.3)	0.437 (11.1)	2 (51)
8	4.570 (116.1)	5.444 (138.3)	0.437 (11.1)	2 (51)
8 1/2	5.660 (143.8)	6.613 (168.0)	0.477 (12.1)	2 (51)
9	5.660 (143.8)	6.613 (168.0)	0.477 (12.1)	2 (51)
9 1/2	6.720 (170.7)	7.875 (200.0)	0.578 (14.7)	2 (51)
10	6.720 (170.7)	7.875 (200.0)	0.578 (14.7)	2 (51)
10 1/2	8.720 (221.5)	10.125 (257.2)	0.703 (17.8)	2 1/2 (64)
11	8.720 (221.5)	10.125 (257.2)	0.703 (17.8)	2 1/2 (64)
11 1/2	10.880 (276.4)	12.150 (308.6)	0.635 (16.1)	2 1/2 (64)
12	10.880 (276.4)	12.150 (308.6)	0.635 (16.1)	2 1/2 (64)
12 1/2	12.880 (327.2)	14.150 (359.4)	0.635 (16.1)	2 1/2 (64)
13	12.880 (327.2)	14.150 (359.4)	0.635 (16.1)	2 1/2 (64)
13 1/2	14.140 (359.2)	15.400 (391.2)	0.630 (16.0)	2 1/2 (64)
14	14.140 (359.2)	15.400 (391.2)	0.630 (16.0)	2 1/2 (64)
14 1/2	16.160 (410.5)	17.400 (442.0)	0.620 (15.7)	2 1/2 (64)
15	16.160 (410.5)	17.400 (442.0)	0.620 (15.7)	2 1/2 (64)
15 1/2	18.180 (461.8)	19.400 (492.8)	0.610 (15.5)	2 1/2 (64)
16	18.180 (461.8)	19.400 (492.8)	0.610 (15.5)	2 1/2 (64)

^A Tolerances shall be (1) Sizes through 3 in. incl: +0.000, -0.010 in. (+0.000, -0.254 mm); (2) Sizes 3 1/2 through 10 in. incl: +0.030, -0.000 in. (+0.762, -0.000 mm); and (3) Sizes above 10 in.: +0.060, -0.000 in. (+1.524, -0.000 mm).

^B Tolerances shall be (1) Sizes through 10 in. incl: +0.125, -0.000 in. (+3.175, -0.000 mm) and (2) Sizes above 10 in.: +1.000, -0.000 in. (+25.4, -0.000 mm).

^C Tolerances for all sizes shall be +0.250, -0.000 in. (+6.4, -0.000 mm).

[†] Editorially corrected.

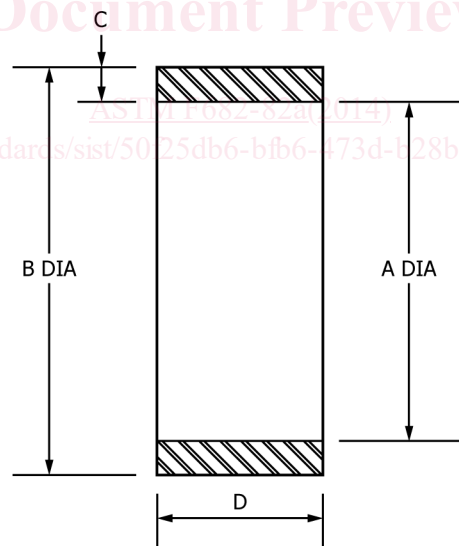

FIG. 1 Sleeve-Type Pipe Coupling

6.1.4 Cold-formed couplings upon which the final forming operation is completed at a temperature below 1150°F (621°C) shall be normalized or shall be stress-relieved at 1100 to 1250°F (593 to 677°C) for 1 h/in. of thickness.

6.1.5 Couplings produced by fusion welding shall be postweld heat treated at 1100 to 1250°F (593 to 677°C), when the nominal wall thickness at the welded joint is 3/4 in. or greater.

6.2 *Carbon Steel Couplings Made from Forgings*—Couplings made from forgings shall subsequently be annealed, normalized, or normalized and tempered.