

INTERNATIONAL STANDARD

ISO
3553-1

First edition
1987-12-01



INTERNATIONAL ORGANIZATION FOR STANDARDIZATION
ORGANISATION INTERNATIONALE DE NORMALISATION
МЕЖДУНАРОДНАЯ ОРГАНИЗАЦИЯ ПО СТАНДАРТИЗАЦИИ

Road vehicles — High-tension connections for ignition coils and distributors —

Part 1:
Socket-type

iTeh STANDARD PREVIEW
(standards.iteh.ai)

Véhicules routiers — Raccords à haute tension pour bobines et distributeurs d'allumage —

Partie 1: Type femelle <https://standards.iteh.ai/catalog/standards/sist/b55b6069-aac9-4da2-943c-ae57da626937/iso-3553-1-1987>

Reference number
ISO 3553-1:1987 (E)

Foreword

ISO (the International Organization for Standardization) is a worldwide federation of national standards bodies (ISO member bodies). The work of preparing International Standards is normally carried out through ISO technical committees. Each member body interested in a subject for which a technical committee has been established has the right to be represented on that committee. International organizations, governmental and non-governmental, in liaison with ISO, also take part in the work.

Draft International Standards adopted by the technical committees are circulated to the member bodies for approval before their acceptance as International Standards by the ISO Council. They are approved in accordance with ISO procedures requiring at least 75 % approval by the member bodies voting.

International Standard ISO 3553-1 was prepared by Technical Committee ISO/TC 22, *Road vehicles*.

This first edition of ISO 3553-1 cancels and replaces ISO 3553:1975, of which it constitutes a minor revision.

<https://standards.iteh.ai/catalog/standards/sist/b55b6069-aac9-4da2-943c-ae57da626937/iso-3553-1-1987>

Users should note that all International Standards undergo revision from time to time and that any reference made herein to any other International Standard implies its latest edition, unless otherwise stated.

Road vehicles — High-tension connections for ignition coils and distributors —

Part 1: Socket-type

iTeh STANDARD PREVIEW (standards.iteh.ai)

0 Introduction

ISO 3553 consists of two parts: <https://standards.iteh.ai/catalog/standards/sist/906069-2019-111-049/ae57da626937/iso-3553-1-1987> and <https://standards.iteh.ai/catalog/standards/sist/906069-2019-111-049/ae57da626937/iso-3553-2-1987>. Type "A" plugs shall meet the dimensions shown in figures 1 and 2.

Part 1: Socket-type.

Part 2: Plug-type.

1 Scope and field of application

This part of ISO 3553 specifies the essential dimensions of high-tension socket-type connections for ignition coils and distributors, used for spark-ignition engines.

This part of ISO 3553 applies to high-tension sockets and to high-tension cable connectors of type "A" (see figures 1 and 2).

NOTE — Type "A" socket and connector is the preferred type. The type "B" socket and connector shown in the annex is accepted.

2 Requirements

Details not specified in this part of ISO 3553 are left to the manufacturer's choice.

2.1 Tower height and depth of socket

The nominal values of dimension A are 10, 14 and 20 mm.

The dimensions A and 10 mm min. shall be measured from the orthogonal reference plane to the vertical axis defined by the greatest diameter of the groove. This diameter need not be situated in the middle of the groove. Only the dimensions specified need be respected.

2.2 Other dimensions

The other dimensions are indicated in figures 1 and 2.

Dimensions in millimetres

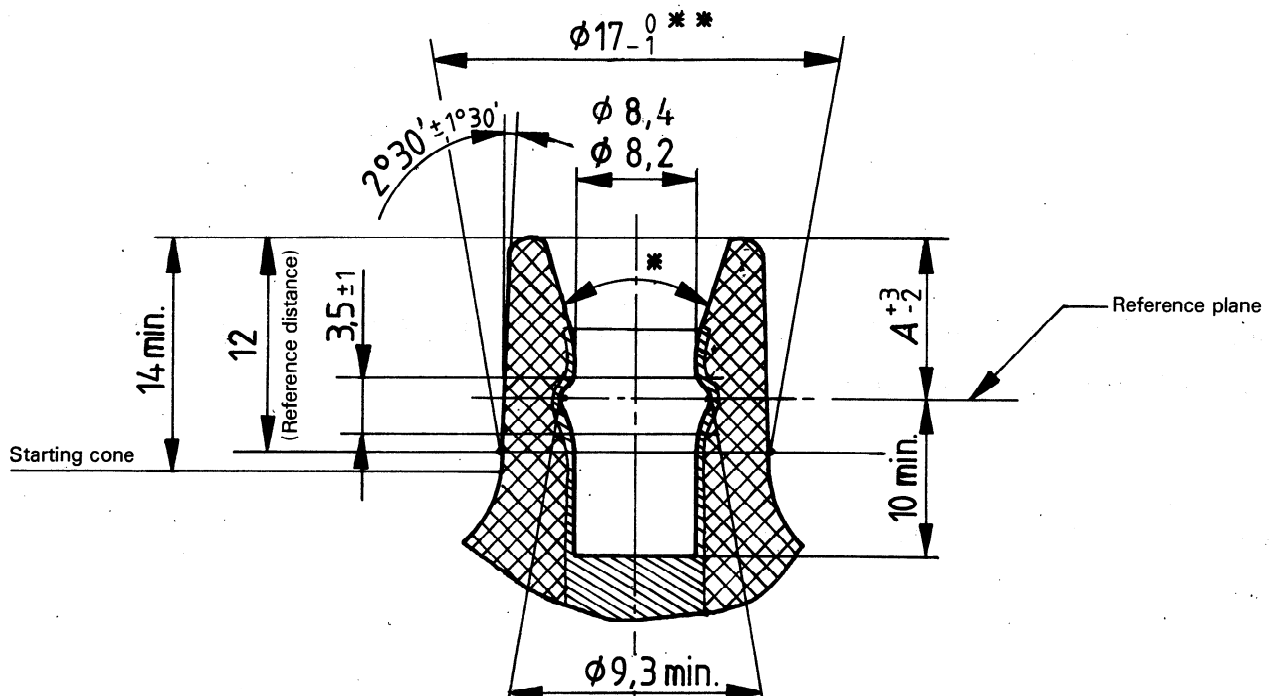

iTeh STANDARD PREVIEW
(standards.iteh.ai)

* Internal taper in the plastic and/or metallic part to facilitate insertion of the connector.

** Instead of the dimension 17_{-1}^{0} mm, the value of 19_{-1}^{0} mm is permitted for coils when the manufacturing method of the high-tension insert so requires.

ISO 3553-1:1987

<https://standards.iteh.ai/catalog/standards/sist/b55b6069-aac9-4da2-943c-ac37da626937/iso-3553-1-1987>

For distributors the outlets of which are perpendicular to the distributor axis and are located on one side, the dimension of $15 \pm 0,5$ mm is permitted.

Figure 1 – Socket type "A"

Dimensions in millimetres

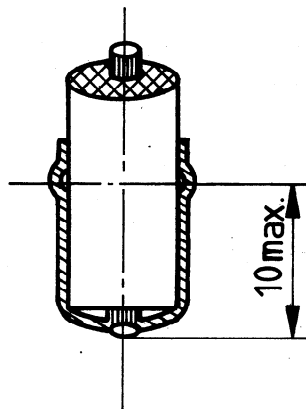

Figure 2 – Connector type "A" (example)

Annex

Socket and connector type "B"

(This annex forms an integral part of the Standard.)

Socket type "B" shall only be used with connector type "B".

Socket type "B" conforms to socket type "A" except for the dimensions shown in figure 3.

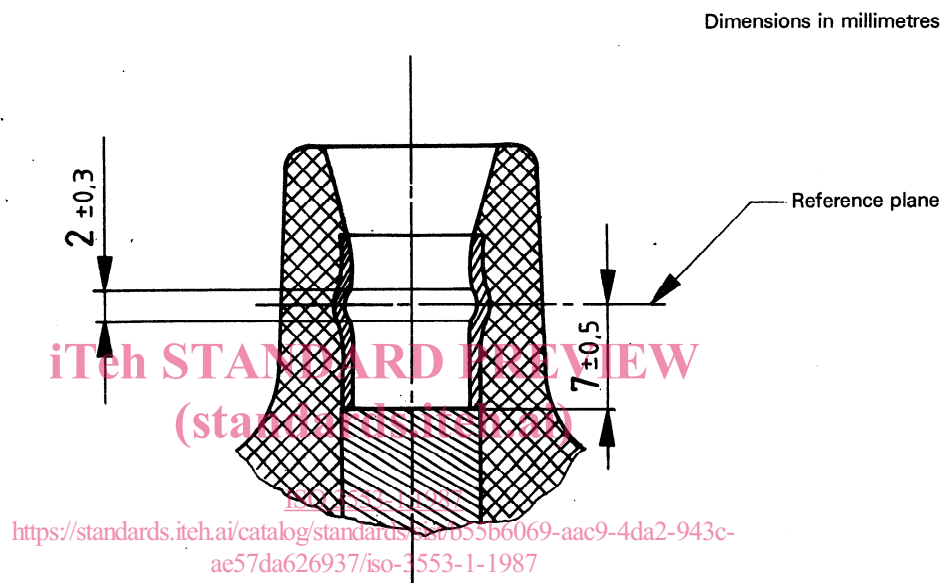

Figure 3 – Socket type "B"

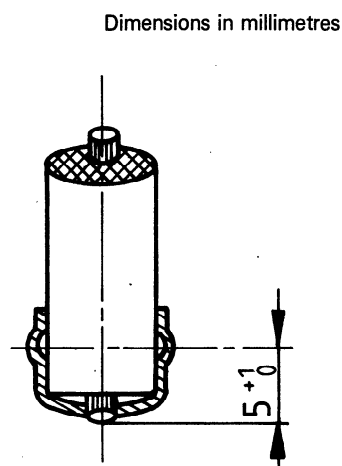

Figure 4 – Connector type "B" (example)

iTeh STANDARD PREVIEW
(standards.iteh.ai)

This page intentionally left blank

[ISO 3553-1:1987](#)

<https://standards.iteh.ai/catalog/standards/sist/b55b6069-aac9-4da2-943c-ae57da626937/iso-3553-1-1987>

iTeh STANDARD PREVIEW
(standards.iteh.ai)

This page intentionally left blank

[ISO 3553-1:1987](#)

<https://standards.iteh.ai/catalog/standards/sist/b55b6069-aac9-4da2-943c-ae57da626937/iso-3553-1-1987>

iTeh STANDARD PREVIEW
(standards.iteh.ai)

ISO 3553-1:1987

<https://standards.iteh.ai/catalog/standards/sist/b55b6069-aac9-4da2-943c-ae57da626937/iso-3553-1-1987>

UDC 629.11 : 621.43.04 : 621.315.68

Descriptors : road vehicles, internal combustion engines, controlled ignition engines, ignition systems, ignition coils, ignition distributors, electric connectors, dimensions.

Price based on 3 pages
