



Designation: F2091 – 15

Standard Specification for Acetabular Prostheses¹

This standard is issued under the fixed designation F2091; the number immediately following the designation indicates the year of original adoption or, in the case of revision, the year of last revision. A number in parentheses indicates the year of last reapproval. A superscript epsilon (ϵ) indicates an editorial change since the last revision or reapproval.

1. Scope

1.1 This specification covers acetabular resurfacing devices used to provide a functioning articulation between the bones of the acetabulum and the femur.

1.2 This specification is intended to provide basic descriptions of materials and device geometry. Additionally, those characteristics determined to be important to *in vivo* performance of the device are defined.

1.3 Acetabular prostheses included within the scope of this specification are intended for fixation by press-fit between the prosthesis and host bone, the use of bone cement, the use of bone screws or similar means of mechanical fixation, or through biological fixation of host bone and/or soft connective tissue into a porous surface.

1.4 Custom (designed explicitly for a single patient), revision, or constrained acetabular prostheses are not covered within the scope of this specification.

1.5 This specification does not cover the details for quality assurance, design control, production control contained in 21 CFR 820 (Quality System Regulation) and ISO 9001.

2. Referenced Documents

2.1 ASTM Standards:²

F67 Specification for Unalloyed Titanium, for Surgical Implant Applications (UNS R50250, UNS R50400, UNS R50550, UNS R50700)

F75 Specification for Cobalt-28 Chromium-6 Molybdenum Alloy Castings and Casting Alloy for Surgical Implants (UNS R30075)

F86 Practice for Surface Preparation and Marking of Metallic Surgical Implants

F90 Specification for Wrought Cobalt-20Chromium-15Tungsten-10Nickel Alloy for Surgical Implant Applications (UNS R30605)

F136 Specification for Wrought Titanium-6Aluminum-4Vanadium ELI (Extra Low Interstitial) Alloy for Surgical Implant Applications (UNS R56401)

F138 Specification for Wrought 18Chromium-14Nickel-2.5Molybdenum Stainless Steel Bar and Wire for Surgical Implants (UNS S31673)

F562 Specification for Wrought 35Cobalt-35Nickel-20Chromium-10Molybdenum Alloy for Surgical Implant Applications (UNS R30035)

F601 Practice for Fluorescent Penetrant Inspection of Metallic Surgical Implants

F603 Specification for High-Purity Dense Aluminum Oxide for Medical Application

F629 Practice for Radiography of Cast Metallic Surgical Implants

F648 Specification for Ultra-High-Molecular-Weight Polyethylene Powder and Fabricated Form for Surgical Implants

F746 Test Method for Pitting or Crevice Corrosion of Metallic Surgical Implant Materials

F748 Practice for Selecting Generic Biological Test Methods for Materials and Devices

F799 Specification for Cobalt-28Chromium-6Molybdenum Alloy Forgings for Surgical Implants (UNS R31537, R31538, R31539)

F981 Practice for Assessment of Compatibility of Biomaterials for Surgical Implants with Respect to Effect of Materials on Muscle and Bone

F983 Practice for Permanent Marking of Orthopaedic Implant Components

F1044 Test Method for Shear Testing of Calcium Phosphate Coatings and Metallic Coatings

F1108 Specification for Titanium-6Aluminum-4Vanadium Alloy Castings for Surgical Implants (UNS R56406)

F1147 Test Method for Tension Testing of Calcium Phosphate and Metallic Coatings

F1160 Test Method for Shear and Bending Fatigue Testing of Calcium Phosphate and Metallic Medical and Composite Calcium Phosphate/Metallic Coatings

¹ This specification is under the jurisdiction of ASTM Committee F04 on Medical and Surgical Materials and Devices and is the direct responsibility of Subcommittee F04.22 on Arthroplasty.

Current edition approved March 15, 2015. Published May 2015. Originally approved in 2001. Last previous edition approved in 2012 as F2091 – 01 (2012). DOI: 10.1520/F2091-15.

² For referenced ASTM standards, visit the ASTM website, www.astm.org, or contact ASTM Customer Service at service@astm.org. For *Annual Book of ASTM Standards* volume information, refer to the standard's Document Summary page on the ASTM website.

- F1185** Specification for Composition of Hydroxylapatite for Surgical Implants
- F1377** Specification for Cobalt-28Chromium-6Molybdenum Powder for Coating of Orthopedic Implants (UNS R30075)
- F1472** Specification for Wrought Titanium-6Aluminum-4Vanadium Alloy for Surgical Implant Applications (UNS R56400)
- F1537** Specification for Wrought Cobalt-28Chromium-6Molybdenum Alloys for Surgical Implants (UNS R31537, UNS R31538, and UNS R31539)
- F1580** Specification for Titanium and Titanium-6 Aluminum-4 Vanadium Alloy Powders for Coatings of Surgical Implants
- F1714** Guide for Gravimetric Wear Assessment of Prosthetic Hip Designs in Simulator Devices
- F1820** Test Method for Determining the Forces for Disassembly of Modular Acetabular Devices
- F1978** Test Method for Measuring Abrasion Resistance of Metallic Thermal Spray Coatings by Using the Taber Abraser
- F2033** Specification for Total Hip Joint Prosthesis and Hip Endoprosthesis Bearing Surfaces Made of Metallic, Ceramic, and Polymeric Materials
- F2565** Guide for Extensively Irradiation-Crosslinked Ultra-High Molecular Weight Polyethylene Fabricated Forms for Surgical Implant Applications
- F2582** Test Method for Impingement of Acetabular Prostheses
- 2.2 ISO Standards:**
- ISO 5832-1, -3, -4, -9, -12, -12/Cor:1, -14** Implants for surgery—Metallic materials for surgical implants³
- ISO 5834-1, -2, -3, -4, -5** Implants for surgery—Ultra high molecular weight polyethylene³
- ISO 6474-1** Implants for surgery—Ceramic materials based on high purity alumina³
- ISO 6474-2** Implants for surgery—Ceramic materials—Part 2: Composite materials based on a high-purity alumina matrix with zirconia reinforcement³
- ISO 9001** Quality systems—Model for quality assurance in design/development, production, installation, and servicing³
- ISO 14242-1** Implants for surgery—Wear of total hip-joint prostheses—Part 1: Loading and displacement parameters for wear-testing machines and corresponding environmental conditions for test³
- ISO 14242-2** Implants for surgery—Wear of total hip-joint prostheses—Part 2: Methods of measurement³
- ISO 14242-3** Implants for surgery—Wear of total hip joint prostheses—Part 3: Loading and displacement parameters for orbital bearing type wear testing machines and corresponding environmental conditions for test³
- ISO 21535** Non-active surgical implants—Joint replacement implants—Specific requirements for hip-joint replacement implant³

2.3 Code of Federal Regulations:
21 CFR 820 Quality System Regulation⁴

3. Terminology

3.1 Definitions:

3.1.1 *bearing element, n*—articulating surface element between the femoral head and shell or bonding agent (bone cement).

3.1.2 *cavity, n*—any slot, cut, hole, or other feature within the shell intended to accommodate modular adjunct fixation elements; instruments for insertion, extraction, and so forth; or for manufacturing purposes.

3.1.3 *fixation element, n*—any peg, spike, threadform, or other protrusion from the exterior surface of the shell intended to increase the surface contact or mechanical interlock between the component, the bonding agent, the natural acetabulum, or a combination thereof.

3.1.4 *flange, n*—rim extending from the entry diameter of bearing element.

3.1.5 *porous surface, n*—a region on the exterior surface of the shell characterized by interconnecting subsurface pores, generally with volume porosity between 30 and 70 %, average pore size between 100 and 1000 μm, and a thickness between 500 and 1500 μm. This porous layer may be manufactured directly into the device by casting or by various electro/chemical/thermal/mechanical means, or applied as a coating of particles, beads, or mesh by processes such as sintering or plasma spray.

3.1.6 *radiographic marker, n*—nonstructural, generally thin wire, designed to be apparent on X-rays taken after placement of implants that otherwise would be unapparent on such X-rays.

3.1.7 *retention element, n*—any ring, taper, wire, or other protrusion or cavity from the interior surface of the shell or the exterior surface of the bearing element that is intended to affix the bearing element to the shell.

3.1.8 *shell, n*—metal structure supporting the articulating surface material, and which may be fixed rigidly to the articulating surface or fixed such that it allows the articulating surface to rotate or translate.

3.1.9 *surface texturing, n*—repetitive or random deviations from the nominal surface that forms the three dimensional topography of the surface.

3.2 Dimensions of acetabular prostheses should be designated in accordance with **Figs. 1-3** or by an equally acceptable and detailed method.

NOTE 1—**Figs. 1-3** are intended to be illustrative of typical acetabular prostheses and to designate dimensions, but representation of the components does not otherwise form part of the standard.

4. Types

4.1 Acetabular prostheses falling within the scope of this specification are of two types, as defined below. There are no

³ Available from International Organization for Standardization (ISO), 1, ch. de la Voie-Creuse, CP 56, CH-1211 Geneva 20, Switzerland, <http://www.iso.org>.

⁴ Available from Standardization Documents Order Desk, DODSSP, Bldg. 4, Section D, 700 Robbins Ave., Philadelphia, PA 19111-5098, <http://dodssp.daps.dla.mil>.

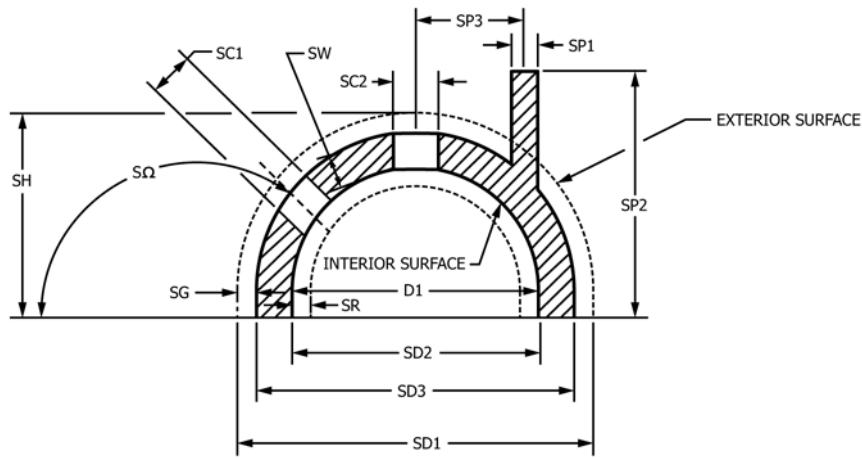

Key:

SD1	Diameter of spherical socket	SR	Retention element distance from SD2
SD2	Retentive or nonretentive entry diameter	SH	Overall height
SD3	Effective spherical external diameter	SQ	Angle from shell face to SC1 center
SC1	Dome cavity diameter (when present)	SP1	Fixation element width or diameter
SC2	Apical cavity diameter (when present)	SP2	Fixation element height
SW	Minimum wall thickness	SP3	Distance to fixation element from shell face
SG	Surface texture or coating depth		

FIG. 1 Shell Cross Section

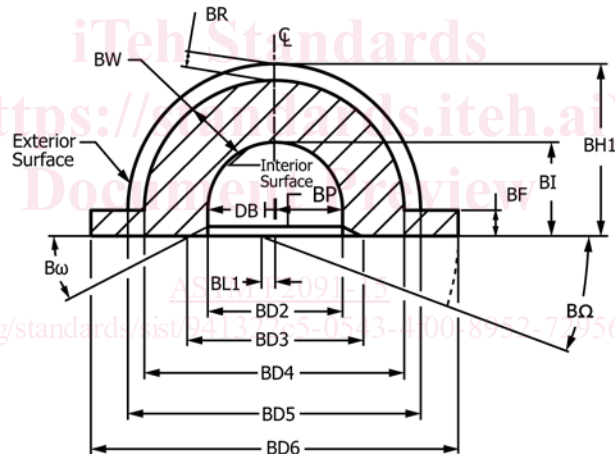

Key:

BD2	Retentive or nonretentive entry diameter	BH1	Distance from bearing element face to dome
BD3	Relief diameter (entry chamfer, if present, need not extend through the whole circumference)	BI	Inside depth
BD4	Effective spherical external diameter	BR	Retention element depth
BD5	Outside diameter of the bearing element	Bω	Angle of chamfer element from BD2 to BD3
BD6	Flange diameter (when present)	BQ	Angle of augmentation of an extended lip
BP	Depth of BD2	BL1	Offset of β from center of BD4
BW	Minimum wall thickness		
BF	Flange thickness (when present)		

FIG. 2 Bearing Element Cross Section

distinguishing features (for example, augmentation or lack thereof, holes, and so forth) that would exempt any device from any requirement of this specification.

4.1.1 *Type I*—Single-piece acetabular prostheses.

NOTE 2—Specifications to both bearing elements and shell may apply.

4.1.2 *Type II*—Multipiece, modular structure prostheses.

5. Material

5.1 The choice of materials is understood to be a necessary, but not sufficient, assurance of function of the device made from them. All devices conforming to this specification shall be fabricated from materials with adequate mechanical strength and durability, corrosion resistance, and biocompatibility.