INTERNATIONAL STANDARD



3860

INTERNATIONAL ORGANIZATION FOR STANDARDIZATION • МЕЖДУНАРОДНАЯ ОРГАНИЗАЦИЯ ПО СТАНДАРТИЗАЦИИ • ORGANISATION INTERNATIONALE DE NORMALISATION

Bore cutters with key drive — Form milling cutters with constant profile

Fraises à alésage lisse à entraînement par clavette — Fraises de forme à profil constant

First edition — 1976-11-01

iTeh STANDARD PREVIEW
(standards.iteh.ai)

[ISO 3860:1976](#)

<https://standards.iteh.ai/catalog/standards/sist/5b1f48f1-dd6d-4449-a93b-8d0960cf95ee/iso-3860-1976>

UDC 621.914.2

Ref. No. ISO 3860-1976 (E)

Descriptors : tools, power-operated tools, milling cutters, key drives, specifications, dimensions.

FOREWORD

ISO (the International Organization for Standardization) is a worldwide federation of national standards institutes (ISO Member Bodies). The work of developing International Standards is carried out through ISO Technical Committees. Every Member Body interested in a subject for which a Technical Committee has been set up has the right to be represented on that Committee. International organizations, governmental and non-governmental, in liaison with ISO, also take part in the work.

Draft International Standards adopted by the Technical Committees are circulated to the Member Bodies for approval before their acceptance as International Standards by the ISO Council.

International Standard ISO 3860 was drawn up by Technical Committee ISO/TC 29, *Small tools*, and was circulated to the Member Bodies in July, 1975.

It has been approved by the Member Bodies of the following countries :

Australia
Austria
Belgium
Bulgaria
Canada
Czechoslovakia
France
Hungary

India
Israel
Italy
Japan
Mexico
Netherlands
Poland
Romania

[ISO 3860:1976](#)

[South Africa, Rep. of](#)

[Spain](#)

[Sweden](#)

[Turkey](#)

[United Kingdom](#)

[U.S.A.](#)

[U.S.S.R.](#)

The Member Bodies of the following countries expressed disapproval of the document on technical grounds :

Germany
Switzerland

Bore cutters with key drive – Form milling cutters with constant profile

iTeh STANDARD PREVIEW (standards.iteh.ai)

1 SCOPE AND FIELD OF APPLICATION

This International Standard lays down the dimensions of bore form milling cutters with a constant profile, with key drive.

It concerns the following types :

- 1) convex milling cutters;
- 2) concave milling cutters;
- 3) corner-rounding cutters.

The interchangeability dimensions of cutters with key drive and arbors are in accordance with ISO 240.

The range of external diameters comes from ISO 523.

2 REFERENCES

ISO 240, *Milling cutters – Interchangeability dimensions for cutter arbors or cutter mandrels – Metric series and inch series.*

ISO 523, *Milling cutters – Recommended range of outside diameters.*

3 DIMENSIONS

3.1 Convex milling cutters

Dimensions in millimetres

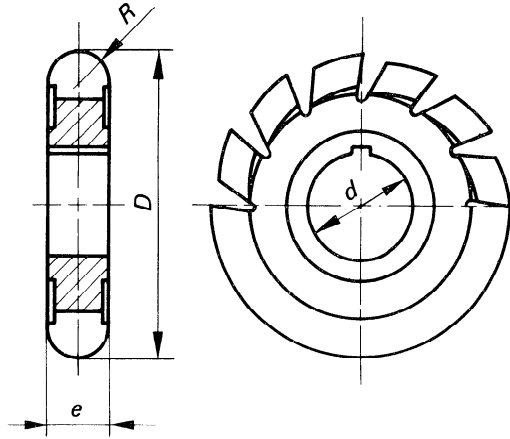

R k11	D js16	d H7	e	
1	50	16	2	
1,25			2,5	
1,6			3,2	
2			4	
2,5	63	22	5	
3,15 (3)*			6,3 (6)	
4			8	
5			10	
6,3 (6)*	80	27	12,6 (12)	
8			16	
10	100	32	20	
12,5 (12)*			25 (24)	
16			32	
20	125		40	

3.2 Concave milling cutters

Dimensions in millimetres

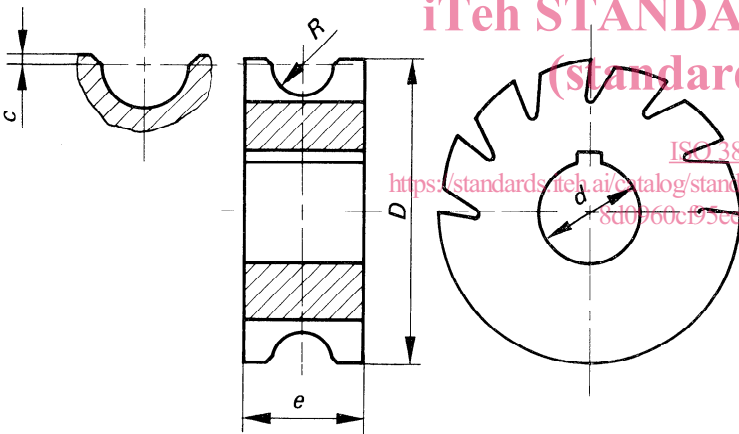

R N11	D js16	d H7	e	c
1	50	16	6	0,2
1,25			8	
1,6			9	
2			10	
2,5	63	22	12	0,3
3,15 (3)*			16	
4			20	
5			24	
6,3 (6)*	80	27	32	0,6
8			36	
10	100	32	40	1,0
12,5 (12)*			50	
16			60	
20	125			2,0

3.3 Corner-rounding cutters

Dimensions in millimetres

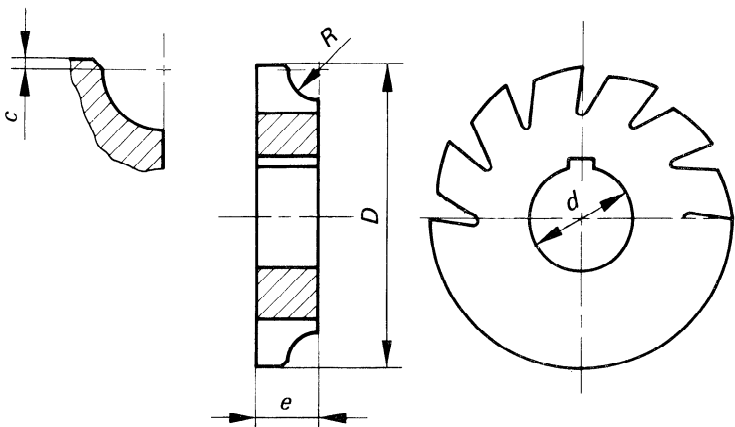

R N11	D js16	d H7	e	c
1	50	16	4	0,2
1,25			5	
1,6			5	0,25
2				
2,5	63	22	6	0,3
3,15 (3)*			8	
4			10	
5			12	
6,3 (6)*	80	27	16	0,6
8			18	
10	100	32	20	1,0
12,5 (12)*			24	
16			28	
20	125			2,0

* Values given in parentheses are alternatives.