International Standard



3914/2

INTERNATIONAL ORGANIZATION FOR STANDARDIZATION • МЕЖДУНАРОДНАЯ ОРГАНИЗАЦИЯ ПО СТАНДАРТИЗАЦИИ • ORGANISATION INTERNATIONALE DE NORMALISATION

Textile machinery — Cylindrical tubes — Part 2 : Tubes for open-end spinning machines

Matériel pour l'industrie textile — Tubes cylindriques — Partie 2 : Tubes pour machines de filature à fibres libérées

First edition — 1981-09-15

iTeh STANDARD PREVIEW
(standards.iteh.ai)

[ISO 3914-2:1981](https://standards.iteh.ai/catalog/standards/sist/e5918083-4ef1-4ca7-a2de-23cb55d2804c/iso-3914-2-1981)

<https://standards.iteh.ai/catalog/standards/sist/e5918083-4ef1-4ca7-a2de-23cb55d2804c/iso-3914-2-1981>

UDC 677.052.96 : 677.052.48

Ref. No. ISO 3914/2-1981 (E)

Descriptors : textile machinery, spinning frames, pipes (tubes), cylinders, dimensions, dimensional tolerances, specifications.

Foreword

ISO (the International Organization for Standardization) is a worldwide federation of national standards institutes (ISO member bodies). The work of developing International Standards is carried out through ISO technical committees. Every member body interested in a subject for which a technical committee has been set up has the right to be represented on that committee. International organizations, governmental and non-governmental, in liaison with ISO, also take part in the work.

Draft International Standards adopted by the technical committees are circulated to the member bodies for approval before their acceptance as International Standards by the ISO Council.

International Standard ISO 3914/2 (formerly ISO/DIS 6172) was developed by Technical Committee ISO/TC 72, *Textile machinery and allied machinery and accessories*, and was circulated to the member bodies in July 1979.

It has been approved by the member bodies of the following countries:

Australia	Germany, F.R.	Poland
Belgium	Indonesia	Spain
Brazil	Japan	Switzerland
Czechoslovakia	Libyan Arab Jamahiriya	United Kingdom
France	Netherlands	USSR

No member body expressed disapproval of the document.

Textile machinery — Cylindrical tubes — Part 2 : Tubes for open-end spinning machines

1 Scope and field of application

This International Standard specifies the main dimensions and the tolerances of cylindrical tubes for open-end spinning machines (for example for rotor spinning). Furthermore, directives are given for the characteristics for the tubes and for the control of the inner diameter and length of the tube.

2 Reference

ISO 3914/1, *Textile machinery — Cylindrical tubes — Part 1 : Recommended values of inner diameters and lengths.*¹⁾

3 Dimensions and tolerances

The values for the inner diameter and the length of the tube are given in the table.

Dimensions which are not specified are left to the discretion of the manufacturer.

Table — Inner diameters and lengths

Values in millimetres

<i>D</i>	<i>L</i>
50* ± 0,2	98* ± 0,5
54* ± 0,2	115 ± 0,5
56 ± 0,2	145 ± 0,5
63 ± 0,2	170 ± 0,5
80 ± 0,25	230 ± 1

* These values are not included in the recommended values listed in ISO 3914/1. Presently these are in worldwide use but should be avoided for new designs.

NOTE — If additional diameters and lengths should become necessary in the future, these shall be chosen from the series given in ISO 3914/1.

4 Characteristics

The following details shall be specified :

- material of the tube;
- nature of the yarn to be wound.

Other details are subject to agreement between the user and the manufacturer.

5 Control of the inner diameter and length of the tube

To check the inner diameter of the tube, a "Go/Not-Go" type gauge has to be used.

To control the tolerances of the length of the tube, a suitable gauge for controlling lengths, for example a slide-gauge, has to be used.

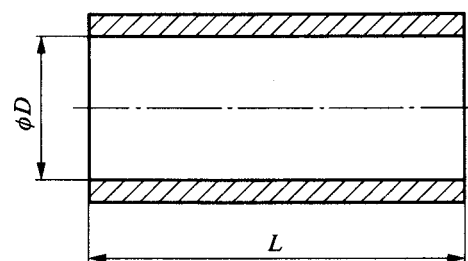

Figure — Cylindrical tube

1) At present at the stage of draft. (Revision of ISO 3914-1976.)

iTeh STANDARD PREVIEW
(standards.iteh.ai)

ISO 3914-2:1981

<https://standards.iteh.ai/catalog/standards/sist/e5918083-4ef1-4ca7-a2de-23cb55d2804c/iso-3914-2-1981>