



Designation: **D2561—12 D2561 – 17**

## Standard Test Method for Environmental Stress-Crack Resistance of Blow-Molded Polyethylene Containers<sup>1</sup>

This standard is issued under the fixed designation D2561; the number immediately following the designation indicates the year of original adoption or, in the case of revision, the year of last revision. A number in parentheses indicates the year of last reapproval. A superscript epsilon ( $\epsilon$ ) indicates an editorial change since the last revision or reapproval.

### 1. Scope\*

1.1 Under certain conditions of stress, and in the presence of environments such as soaps, wetting agents, oils, or detergents, blow-molded polyethylene containers exhibit mechanical failure by cracking at stresses appreciably below those that would cause cracking in the absence of these environments.

1.2 This test method measures the environmental stress crack resistance of blow-molded containers, which is the summation of the influence of container design, resin, blow-molding conditions, post treatment, or other factors that can affect this property. Three procedures are provided as follows:

1.2.1 *Procedure A, Stress-Crack Resistance of Containers to ~~Commercial~~ Potential Stress-cracking Liquids*—This procedure is particularly useful for determining the effect of container design on stress-crack resistance or the stress-crack resistance of a proposed ~~commercial package containing a proprietary container that contains a liquid product.~~

1.2.2 *Procedure B, Stress-Crack Resistance of a Specific Container to Polyoxyethylated Nonylphenol (CAS 68412-54-4), a Stress-Cracking Agent*—The conditions of test described in this procedure are designed for testing containers made from Class 3 polyethylene Specification **D4976**. Therefore, this procedure is recommended for containers made from Class 3 polyethylene only. This procedure is particularly useful for determining the effect of resin on the stress-crack resistance of the container.

1.2.3 *Procedure C, Controlled Elevated Pressure Stress-Crack Resistance of a Specific Container to Polyoxyethylated Nonylphenol (CAS 68412-54-4), a Stress-Cracking Agent*—The internal pressure is controlled at a constant elevated level.

NOTE 1—There are environmental concerns regarding the disposal of Polyoxyethylated Nonylphenol (Nonylphenoxy poly(ethyleneoxy) ethanol (CAS 68412-54-4), for example, Igepal CO-630). Users are advised to consult their supplier or local environmental office and follow the guidelines provided for the proper disposal of this chemical.

1.3 These procedures are not designed to test the propensity for environmental stress cracking in the neck of containers, such as when the neck is subjected to a controlled strain by inserting a plug.<sup>17</sup>

1.4 The values stated in SI units are to be regarded as standard. ~~-c3cb-4f9b-b9f6-a00ee9ee2869/astm-d2561-17~~

NOTE 2—There is no known ISO equivalent to this standard.

1.5 *This standard does not purport to address all of the safety concerns, if any, associated with its use. It is the responsibility of the user of this standard to establish appropriate safety and health practices and determine the applicability of regulatory limitations prior to use.* Specific precautionary statements are given in Section 8 and ~~Note 21 and Note 9.~~

1.6 *This international standard was developed in accordance with internationally recognized principles on standardization established in the Decision on Principles for the Development of International Standards, Guides and Recommendations issued by the World Trade Organization Technical Barriers to Trade (TBT) Committee.*

### 2. Referenced Documents

2.1 *ASTM Standards:*<sup>2</sup>

**D618 Practice for Conditioning Plastics for Testing**

**D4976 Specification for Polyethylene Plastics Molding and Extrusion Materials**

**D5947 Test Methods for Physical Dimensions of Solid Plastics Specimens**

<sup>1</sup> This test method is under the jurisdiction of ASTM Committee **D20** on Plastics and is the direct responsibility of Subcommittee **D20.19** on Film, Sheeting, and Molded Products.

Current edition approved ~~Aug. 1, 2012~~ May 1, 2017. Published ~~September 2012~~ May 2017. Originally approved in 1966. Last previous edition approved in ~~2005~~ 2012 as ~~D2561—95 (2005)-D2561 - 12~~. DOI: ~~10.1520/D2561-12~~ 10.1520/D2561-17.

<sup>2</sup> For referenced ASTM standards, visit the ASTM website, www.astm.org, or contact ASTM Customer Service at service@astm.org. For *Annual Book of ASTM Standards* volume information, refer to the standard's Document Summary page on the ASTM website.

\*A Summary of Changes section appears at the end of this standard

## E145 Specification for Gravity-Convection and Forced-Ventilation Ovens

### 3. Terminology

#### ~~3.1 Definitions of Terms Specific to This Standard:~~

#### 3.1 Definitions of Terms Specific to This Standard:

3.1.1 failure—during this test method, the formation of any imperfection, such as a crack, which results in a loss of pressurizing gas or stress-cracking agent.

##### 3.1.1.1 Discussion—

A container has failed when:

It has lost pressure through any aperture other than heat seal areas; or, in Procedure C, when there is a detectable flow of supply air into the bottle, there is any visible crack completely through the container wall, there is evidence of the contained liquid on the outside of the container through any aperture other than one at the heat-seal area, or the contained liquid volume has been reduced.

3.1.2 potential stress-cracking liquids—a liquid that can contain stress-cracking agents, which have the potential to induce a stress crack in the test containers.

##### 3.1.2.1 Discussion—

Under certain conditions of stress and in the presence of potential stress-cracking liquids such as soaps, wetting agents, oils, or detergents, ethylene plastics may exhibit mechanical failure by cracking.

3.1.3 stress crack—defined as a failure.

~~3.2 failure~~—during this test method, the formation of any imperfection, such as a crack, which results in a loss of pressurizing gas or stress-cracking agent.

##### ~~3.2.1 Discussion~~—

~~A container has failed when:~~

~~It has lost pressure through any aperture other than heat seal areas; or, in Procedure C, when there is a detectable flow of supply air into the bottle, there is any visible crack completely through the container wall, there is evidence of the contained liquid on the outside of the container through any aperture other than one at the heat-seal area, or the contained liquid volume has been reduced.~~

### 4. Summary of Test Method

4.1 Procedure A consists of exposing any filled, sealed, blow-molded container to the action of a potential stress-cracking agent within the container, at an elevated temperature. The time to failure is observed.

4.2 Procedure B consists of exposing a sealed blow-molded standard container, partly filled to one third of overflow capacity, to the action of polyoxyethylated nonylphenol, a stress-cracking agent, within the container, as well as to the action of this agent as an external environment, at an elevated temperature. The time to failure is observed.

4.3 Procedure C consists of exposing a blow-molded standard container, partly filled to one fourth of overflow capacity, to the action of polyoxyethylated nonylphenol, a stress-cracking agent, within the container, as well as to a constant elevated pressure internally applied and at an elevated temperature. The time-to-failure can be determined in a tactual-visual manner, or instrumentally.

NOTE 3—Partial filling, that is, one third of nominal capacity, has been found to increase the severity of the test with many test liquids. Thus, the partial fill can be used to accelerate the test. The use of an elevated controlled pressure as in Procedure C can also accelerate the test.

### 5. Significance and Use

5.1 When properly used, these procedures serve to isolate such factors as material, blow-molding conditions, post-treatment, and so forth, on the stress-crack resistance of the container.

5.2 Environmental stress cracking of blow-molded containers is governed by many factors. Since variance of any of these factors can change the environmental stress-crack resistance of the container, the test results are representative only of a given test performed under defined conditions in the laboratory. The reproducibility of results between laboratories on containers made on more than one machine from more than one mold has not been established.

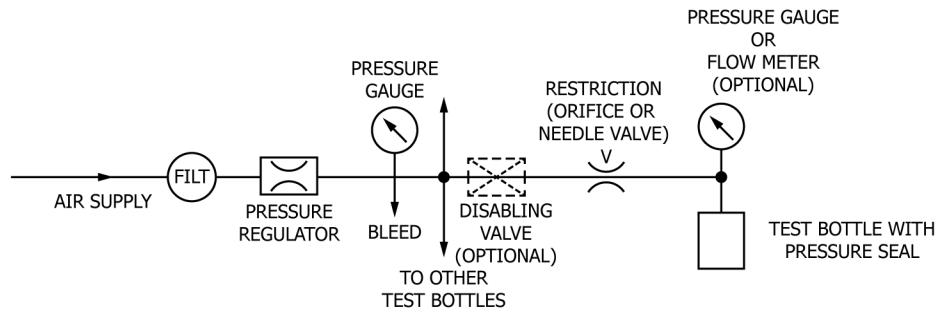

FIG. 1 Apparatus for Procedure C

5.3 Results can be used for estimating the shelf life of blow-molded containers in terms of their resistance to environmental stress cracking provided this is done against a rigorous background of practical field experience and reproducible test data.

## 6. Apparatus

### 6.1 For Procedures A, B, and C:

6.1.1 *Circulating-Air Oven*, consistent with ovens prescribed in Specification E145, except for size, capable of maintaining a temperature of  $60 \pm 1^\circ\text{C}$  ( $140 \pm 1.8^\circ\text{F}$ ) and an airflow rate of 8.5 to 17 m<sup>3</sup>/min (300 to 600 ft<sup>3</sup>/min). (**Warning**— A high-temperature safety switch is highly recommended on this oven. Some test liquids can cause extreme pressure buildup upon heating. Under these conditions bottles can rupture with explosive force. This condition can cause injury to the operator as well as damage to the ovens. The override cutoff switch should be set to turn off the oven heat if the test temperature is exceeded by as much as 10°C (18°F). )

6.1.2 *Balance*, accurate to within  $\pm 1.0$  g (for weighing containers and contents) or a volumetric filling apparatus accurate to  $\pm 1$  mL.

### 6.2 For Procedures A and B Only:

6.2.1 *Heat-Seal Laminate* for sealing the containers.

6.2.2 *Heat-Sealing Unit*.

6.2.3 *Torque Meter*.

6.2.4 *Glass Beakers*, large enough to hold the contents of one test container.

### 6.3 For Procedures A and C Only:

6.3.1 *Polyethylene Bags*, approximately 0.038-mm (1.5-mil) thick, large enough to enclose completely a test container. The bag should fit loosely around the container and be long enough so that the bag opening can be closed above the container closure.

### 6.4 For Procedure C Only:

6.4.1 The essential parts of this apparatus are schematically shown in Fig. 1. Additional refinements in failure detection can be added as shown in Fig. 2. The necessary equipment is as follows:

6.4.1.1 *Clear Air Supply* of sufficient pressure to operate regulator and maintain regulated pressure to manifold.

6.4.1.2 *Air Filter*, to remove oil, water, dust, and other contaminants.

6.4.1.3 *Pressure Regulator*, to reduce line pressure to  $34.5 \pm 1.72$  kPa ( $5.0 \pm 0.25$  psig).

6.4.1.4 *Pressure Gages/Gauges*, calibrated to indicate a pressure of 34.5 kPa (5.0 psig) with a precision of 0.34 kPa (0.05 psig).

NOTE 4—A non-mercury manometer is of benefit in calibrating the pressure gages/gauges, and monitoring precise pressure measurements.

6.4.1.5 *Air Valves—Air Valves*.

6.4.1.6 *Restricting Line Orifice or Needle Valve*—This restriction retards the flow of air to the bottle so that supply pressure remains constant after bottle failure, enabling a number of bottles to be pressurized from a single regulated supply. Pressure drop on the bottle side of this restriction is one indication of bottle failure. The orifice size or restriction used will depend upon the sensitivity of the pressure switch or gage/gauge. Orifices that pass 300 cm<sup>3</sup>/min at 6.9 kPa (1 psi) differential pressure have been found satisfactory. Needle valves, which may can be adjusted to flow rates as low as 5.0 cm<sup>3</sup>/min, may can be useful in cases where greater sensitivity to small failures is desired.

6.4.1.7 *Bottle Cap Assemblies*—Each bottle must be securely sealed and attached to the test fixture. Assemblies essentially like those shown in Fig. 3 have been found satisfactory.

## 7. Reagents

7.1 *For Procedure A*—Any reagent or proprietary liquid that is potentially an environmental stress-cracking agent.

7.2 *For Procedure B*:

7.2.1 *Polyoxyethylated Nonylphenol (CAS 68412-54-4)*, a stress-cracking agent.

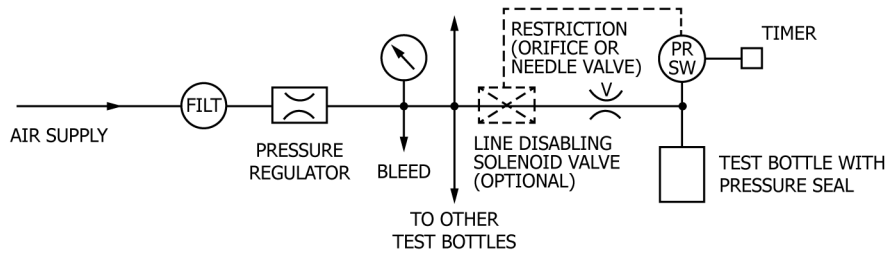

FIG. 2 Apparatus for Procedure C, Including Refinements in Failure Detection

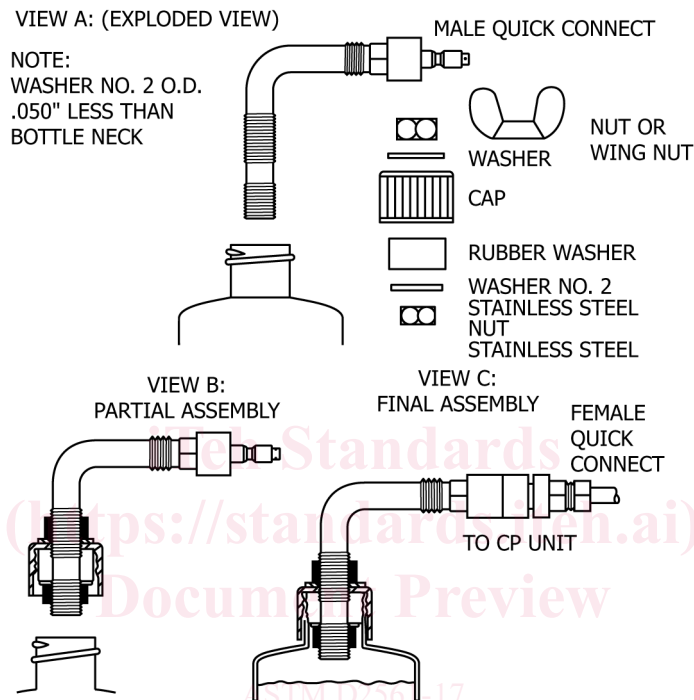

FIG. 3 Bottle Pressure Seal and Tube

NOTE 5—Polyoxyethylated nonylphenol is hygroscopic and the undiluted agent should be kept tightly stoppered.

7.2.2 *Polyoxyethylated Nonylphenol Solution*—Prepare a 10 % solution, by volume, of the stress-cracking agent in distilled or deionized water in sufficient volume to fill a minimum of fifteen 473-mL (16-oz) containers to one third of overflow capacity (178 mL).

NOTE 6—It has been found to be helpful due to the viscosity of the stress-cracking agent, to prepare the solution at an elevated temperature. A temperature of 50°C (120°F) has been found suitable.

7.2.3 *Dye Indicator Solution*—Add 0.1 % by weight of a wetting agent (Dioctyl sodium sulfosuccinate—CAS Number 577-11-7) to distilled or deionized water. Dissolve 0.001 % by weight of Gentian Violet in the water.

NOTE 7—Since only about 0.1 mL (2 drops) of this solution is added to each bottle, only a small volume is needed.

7.3 *For Procedure C:*

7.3.1 *Polyoxyethylated Nonylphenol*, a stress-cracking agent. See [Note 5](#).

7.3.2 *Polyoxyethylated Nonylphenol Solution*—Prepare a 33⅓ % solution by volume, of the stress-cracking agent in distilled or deionized water in sufficient volume to fill a minimum of fifteen 473-mL (16-oz) containers to one fourth of the overflow capacity (133 mL). See [Note 6](#).

## 8. Safety Precautions

8.1 Proper precautions are required to prevent overheating of the containers during testing since some products tested by Procedure A can create an extreme pressure buildup in the container causing the container to rupture explosively. Proper safety measures against over-heating are described in the warning note at the end of [6.1.1](#).