International Standard



4165

INTERNATIONAL ORGANIZATION FOR STANDARDIZATION • МЕЖДУНАРОДНАЯ ОРГАНИЗАЦИЯ ПО СТАНДАРТИЗАЦИИ • ORGANISATION INTERNATIONALE DE NORMALISATION

Road vehicles — Electrical connections — Double-pole connector

Véhicules routiers — Connexions électriques — Prise bipolaire

First edition — 1979-07-15

ISO 4165:1979
https://standards.iteh.ai/catalog/standards/sist/cd129f74-5034-4555-9912-0ae35113c826/iso-4165-1979
iTech STANDARD PREVIEW
(standards.iteh.ai)

UDC 629.113.066 : 621.315.683

Ref. No. ISO 4165-1979 (E)

Descriptors : road vehicles, electric connections, electric outlets, socket connectors, plug connectors, dimensions.

ITeH STANDARD PREVIEW (standards.iteh.ai)

ISO 4165:1979

<https://standards.iteh.ai/catalog/standards/sist/cdl29f74-5034-4555-9912-0ae35113c826/iso-4165-1979>

Foreword

ISO (the International Organization for Standardization) is a worldwide federation of national standards institutes (ISO member bodies). The work of developing International Standards is carried out through ISO technical committees. Every member body interested in a subject for which a technical committee has been set up has the right to be represented on that committee. International organizations, governmental and non-governmental, in liaison with ISO, also take part in the work.

Draft International Standards adopted by the technical committees are circulated to the member bodies for approval before their acceptance as International Standards by the ISO Council.

International Standard ISO 4165 was developed by Technical Committee ISO/TC 22, *Road vehicles*, and was circulated to the member bodies in April 1978.

It has been approved by the member bodies of the following countries :

Australia	Italy	South Africa, Rep. of
Austria	Japan	Spain
Belgium	Korea, Dem. P. Rep. of	Sweden
Bulgaria	Korea, Rep. of	Switzerland
Chile	Mexico	Turkey
Czechoslovakia	Netherlands	United Kingdom
France	New Zealand	USSR
Germany, F. R.	Poland	
Iran	Romania	

No member body expressed disapproval of the document.

Road vehicles — Electrical connections — Double-pole connector

1 Scope and field of application

This International Standard specifies characteristics of the double-pole connector for special warning lights and for hand lamps.

2 Specifications

2.1 The plug and the socket shall have the dimensions shown in figures 1 and 2 respectively. Details not specified are left to the manufacturer's choice.

2.2 The resilient pin of the plug shall be capable of being introduced into the hole with diameter 12 H11 mm of the socket with a moderate push, while ensuring a good electrical contact.

2.3 The internal dimensions of the contact springs of the socket shall be such that the pin with diameter 5 h11 mm can be introduced with a moderate push, while ensuring a good electrical contact.

2.4 If there is no undercut below the length of 11 mm min., this dimension shall be 12,5 mm min.

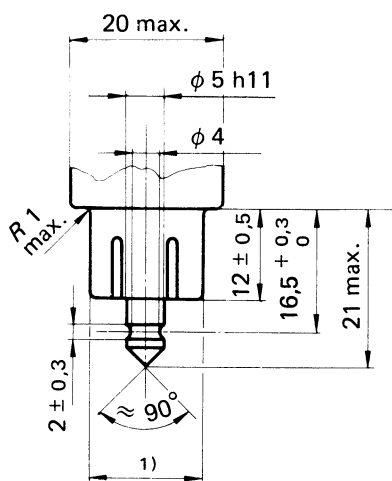
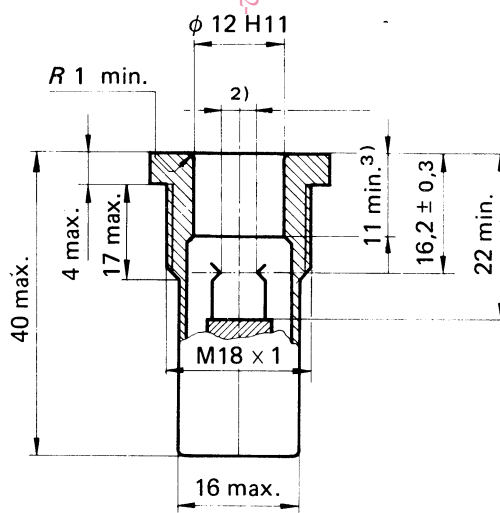

Figure 1 — Plug



2) See 2.3.
3) See 2.4.

Figure 2 — Socket

Dimensions in millimetres

ITeh STANDARD PREVIEW **(standards.iteh.ai)**

ISO 4165:1979

<https://standards.iteh.ai/catalog/standards/sist/cdl29f74-5034-4555-9912-0ae35113c826/iso-4165-1979>

This page intentionally left blank