

INTERNATIONAL STANDARD

**Electric motor-operated hand-held tools, transportable tools and lawn and garden machinery - Safety -
Part 4-11: Particular requirements for edgers**

get full document from standards.iteh.ai



THIS PUBLICATION IS COPYRIGHT PROTECTED

Copyright © 2026 IEC, Geneva, Switzerland

All rights reserved. Unless otherwise specified, no part of this publication may be reproduced or utilized in any form or by any means, electronic or mechanical, including photocopying and microfilm, without permission in writing from either IEC or IEC's member National Committee in the country of the requester. If you have any questions about IEC copyright or have an enquiry about obtaining additional rights to this publication, please contact the address below or your local IEC member National Committee for further information.

IEC Secretariat
3, rue de Varembe
CH-1211 Geneva 20
Switzerland

Tel.: +41 22 919 02 11
info@iec.ch
www.iec.ch

About the IEC

The International Electrotechnical Commission (IEC) is the leading global organization that prepares and publishes International Standards for all electrical, electronic and related technologies.

About IEC publications

The technical content of IEC publications is kept under constant review by the IEC. Please make sure that you have the latest edition, a corrigendum or an amendment might have been published.

IEC publications search -

webstore.iec.ch/advsearchform

The advanced search enables to find IEC publications by a variety of criteria (reference number, text, technical committee, ...). It also gives information on projects, replaced and withdrawn publications.

IEC Just Published - webstore.iec.ch/justpublished

Stay up to date on all new IEC publications. Just Published details all new publications released. Available online and once a month by email.

IEC Customer Service Centre - webstore.iec.ch/csc

If you wish to give us your feedback on this publication or need further assistance, please contact the Customer Service Centre: sales@iec.ch.

IEC Products & Services Portal - products.iec.ch

Discover our powerful search engine and read freely all the publications previews, graphical symbols and the glossary. With a subscription you will always have access to up to date content tailored to your needs.

Electropedia - www.electropedia.org

The world's leading online dictionary on electrotechnology, containing more than 22 500 terminological entries in English and French, with equivalent terms in 25 additional languages. Also known as the International Electrotechnical Vocabulary (IEV) online.

Warning! Make sure that you obtained this publication from an authorized distributor.

CONTENTS

FOREWORD	4
1 Scope	6
2 Normative references	6
3 Terms and definitions	7
4 General requirements	12
5 General conditions for the tests	13
6 Radiation, toxicity and similar hazards	13
7 Classification	13
8 Marking and instructions	14
9 Protection against access to live parts	18
10 Starting	18
11 Input and current	18
12 Heating	19
13 Resistance to heat and fire	20
14 Moisture resistance	20
15 Resistance to rusting	21
16 Overload protection of transformers and associated circuits	22
17 Endurance	22
18 Abnormal operation	22
19 Mechanical hazards	24
20 Mechanical strength	35
21 Construction	40
22 Internal wiring	46
23 Components	46
24 Supply connection and external flexible cords	47
25 Terminals for external conductors	48
26 Provision for earthing	48
27 Screws and connections	48
28 Creepage distances, clearances and distances through insulation	48
Annexes	54
Annex I (informative) Measurement of noise and vibration emissions	55
Annex K (normative) Battery tools and battery packs	63
Annex L (normative) Battery tools and battery packs provided with mains connection or non-isolated sources	76
Annex AA (normative) Product safety labels which may be used on machines	81
Annex BB (normative) Impact test for cutting accessories and freely pivoting non- metallic cutting elements of walk-beside edgers and walk-behind edgers	86
Annex CC (normative) Impact test for cutting accessories and freely pivoting non- metallic cutting elements of hand-held edgers	88
Annex DD (informative) Example of a material and construction fulfilling the requirements for an artificial surface	90
Annex EE (normative) Test surface	92
Bibliography	94

Figure 101 – Example of a hand-held edger	10
Figure 102 – Example of a walk-behind edger	11
Figure 103 – Example of a walk-beside edger	12
Figure 104 – Distance between the rear of rotating cutting means or cutting accessory and the foremost working position of the handle	25
Figure 105 – Foot probe.....	25
Figure 106 – Minimum guard dimensions	26
Figure 107 – Hand-held edger, distance D	27
Figure 108 – 50 % depth setting for hand-held edger	28
Figure 109 – Operator line of sight for hand-held and walk-beside edger.....	29
Figure 110 – Operator line of sight for walk-behind edger	30
Figure 111 – Measurement of handle gripping length	33
Figure 112 – Walk-beside edger, distance D	34
Figure 113 – Impact test apparatus for handle insulation	38
Figure 114 – Example of an operator presence sensor	42
Figure 115 – Application of steel rod when rotated around the handle.....	42
Figure 116 – Application of steel rod when applied in the direction perpendicular to the handle axis	43
Figure 117 – Edger cutting means measurement	45
Figure 118 – Test assembly for accessibility of attachment plug blades.....	47
Figure I.101 – Microphone positions on the hemisphere (see Table I.101).....	55
Figure I.102 – Examples of positions of transducers (hand-held and walk-beside machines).....	61
Figure I.103 – Examples of positions of transducers (walk-behind machines).....	61
Figure AA.1 – Product safety labels illustrating – "Wear eye protection"	81
Figure AA.2 – Product safety label illustrating – "Wear ear protection"	81
Figure AA.3 – Optional product safety label illustrating – "Wear eye and ear protection"	82
Figure AA.4 – Product safety labels illustrating – "WARNING – Keep bystanders away"	82
Figure AA.5 – Product safety labels illustrating – "WARNING – Beware of thrown objects"	83
Figure AA.6 – Product safety label illustrating – "Do not expose to rain".....	83
Figure AA.7 – Product safety label illustrating – "Do not use metal blades".....	84
Figure AA.8 – Product safety label illustrating – "WARNING – Remove plug from the mains immediately if the power cord or cable is damaged or cut".....	84
Figure AA.9 – Product safety label illustrating – "WARNING – Disconnect battery before maintenance".....	84
Figure AA.10 – Product safety label illustrating – "WARNING – Remove the disabling device before maintenance".....	85
Figure AA.11 – Product safety label illustrating – "WARNING – Operate the disabling device before maintenance".....	85
Figure BB.1 – Example of impact test fixture (walk-beside edgers and walk-behind edgers).....	87
Figure CC.1 – Hand-held edger impact test.....	89
Figure DD.1 – Sketch of the measurement surface covered with an artificial surface (not to scale).....	91
Figure EE.1 – Test surface detail	92

Figure EE.2 – Example of test surface, nail plan	93
Table 2 – Maximum outside surface temperature rises	20
Table 4 – Required performance levels.....	23
Table 7 – Switch trigger force	40
Table 9 – Pull and torque value.....	48
Table 12 – Minimum creepage distances and clearances.....	50
Table I.101 – Co-ordinates of microphone positions	57
Table I.102 – Absorption coefficients	58
Table 4 – Required performance levels.....	68
Table 301 – Pull and torque value	73
Table K.1 – Minimum creepage distances and clearances between parts of different potential	74
Table K.2 – Minimum total sum of creepage distances and clearances to accessible surfaces	75

Sample Document

get full document from standards.iteh.ai

INTERNATIONAL ELECTROTECHNICAL COMMISSION

**Electric motor-operated hand-held tools, transportable tools and
lawn and garden machinery - Safety -
Part 4-11: Particular requirements for edgers**

FOREWORD

- 1) The International Electrotechnical Commission (IEC) is a worldwide organization for standardization comprising all national electrotechnical committees (IEC National Committees). The object of IEC is to promote international co-operation on all questions concerning standardization in the electrical and electronic fields. To this end and in addition to other activities, IEC publishes International Standards, Technical Specifications, Technical Reports, Publicly Available Specifications (PAS) and Guides (hereafter referred to as "IEC Publication(s)"). Their preparation is entrusted to technical committees; any IEC National Committee interested in the subject dealt with may participate in this preparatory work. International, governmental and non-governmental organizations liaising with the IEC also participate in this preparation. IEC collaborates closely with the International Organization for Standardization (ISO) in accordance with conditions determined by agreement between the two organizations.
- 2) The formal decisions or agreements of IEC on technical matters express, as nearly as possible, an international consensus of opinion on the relevant subjects since each technical committee has representation from all interested IEC National Committees.
- 3) IEC Publications have the form of recommendations for international use and are accepted by IEC National Committees in that sense. While all reasonable efforts are made to ensure that the technical content of IEC Publications is accurate, IEC cannot be held responsible for the way in which they are used or for any misinterpretation by any end user.
- 4) In order to promote international uniformity, IEC National Committees undertake to apply IEC Publications transparently to the maximum extent possible in their national and regional publications. Any divergence between any IEC Publication and the corresponding national or regional publication shall be clearly indicated in the latter.
- 5) IEC itself does not provide any attestation of conformity. Independent certification bodies provide conformity assessment services and, in some areas, access to IEC marks of conformity. IEC is not responsible for any services carried out by independent certification bodies.
- 6) All users should ensure that they have the latest edition of this publication.
- 7) No liability shall attach to IEC or its directors, employees, servants or agents including individual experts and members of its technical committees and IEC National Committees for any personal injury, property damage or other damage of any nature whatsoever, whether direct or indirect, or for costs (including legal fees) and expenses arising out of the publication, use of, or reliance upon, this IEC Publication or any other IEC Publications.
- 8) Attention is drawn to the Normative references cited in this publication. Use of the referenced publications is indispensable for the correct application of this publication.
- 9) IEC draws attention to the possibility that the implementation of this document may involve the use of (a) patent(s). IEC takes no position concerning the evidence, validity or applicability of any claimed patent rights in respect thereof. As of the date of publication of this document, IEC had not received notice of (a) patent(s), which may be required to implement this document. However, implementers are cautioned that this may not represent the latest information, which may be obtained from the patent database available at <https://patents.iec.ch>. IEC shall not be held responsible for identifying any or all such patent rights.

IEC 62841-4-11 has been prepared by IEC technical committee 116: Safety of motor-operated electric tools. It is an International Standard.

The text of this International Standard is based on the following documents:

Draft	Report on voting
116/945/FDIS	116/974/RVD

Full information on the voting for its approval can be found in the report on voting indicated in the above table.

The language used for the development of this International Standard is English.

This document was drafted in accordance with ISO/IEC Directives, Part 2, and developed in accordance with ISO/IEC Directives, Part 1 and ISO/IEC Directives, IEC Supplement, available at www.iec.ch/members_experts/refdocs. The main document types developed by IEC are described in greater detail at www.iec.ch/publications.

This document is to be used in conjunction with the first edition of IEC 62841-1:2014 and IEC 62841-1:2014/AMD1:2025.

This document supplements or modifies the corresponding clauses in IEC 62841-1:2014, so as to convert it into the IEC Standard: Particular requirements for edgers.

Where a particular subclause of IEC 62841-1:2014 is not mentioned in this document, that subclause applies as far as reasonable. Where this document states "addition", "modification" or "replacement", the relevant text in IEC 62841-1 is to be adapted accordingly.

The following print types are used:

- requirements: in roman type;
- *test specifications: in italic type;*
- notes: in small roman type.

The terms defined in Clause 3 are printed in **bold typeface**.

Subclauses, notes, tables and figures which are additional to those in IEC 62841-1:2014 are numbered starting from 101.

Subclauses, notes, tables and figures in Annex K and Annex L which are additional to those in the main body of this document are numbered starting from 301.

NOTE The attention of National Committees is drawn to the fact that equipment manufacturers and testing organizations can need a transitional period following publication of a new, amended or revised IEC publication in which to make products in accordance with the new requirements and to equip themselves for conducting new or revised tests.

It is the recommendation of the committee that the content of this publication be adopted for implementation nationally not earlier than 36 months from the date of publication.

A list of all parts in the IEC 62841 series, published under the general title *Electric motor-operated hand-held tools, transportable tools and lawn and garden machinery - Safety*, can be found on the IEC website.

The committee has decided that the contents of this document will remain unchanged until the stability date indicated on the IEC website under webstore.iec.ch in the data related to the specific document. At this date, the document will be

- reconfirmed,
- withdrawn, or
- revised.

1 Scope

IEC 62841-1:2014, Clause 1 is applicable, except as follows:

Addition:

This document applies to the following types of **edgers**

- **hand-held edgers** having at least one ground-support;
- **walk-behind edgers** and **walk-beside edgers**, where the plane of the **blade-tip circle** is designed to operate at not more than 15° from the vertical.

The **edgers** to which this document applies have a **blade-tip circle** diameter of not more than 305 mm, and are equipped with a

- **cutting accessory**; or
- **cutting means** with one or more **cutting elements** pivotally mounted on a generally circular drive unit and have a kinetic energy for each single **cutting element** of greater than 10 J.

NOTE 101 Machines having **cutting elements** with a kinetic energy not exceeding 10 J are considered to be lawn edge trimmers and are covered by IEC 62841-4-4.

This document does not apply to

- lawn trimmers, lawn edge trimmers, grass trimmers, brush cutters and brush saws;
- scissor type **edgers** and brush cutters; and
- machines equipped with metallic **cutting accessories** consisting of more than one piece, e.g. pivoting chains or flail blades.

NOTE 102 Lawn trimmers, lawn edge trimmers, brush cutters and brush saws are covered by IEC 62841-4-4.

NOTE 103 Scissor type **edgers** and brush cutters will be covered by a future part of IEC 62841.

NOTE 104 In Europe (EN IEC 62841-4-11), this document does not apply to **edgers** equipped with **integral batteries**.

2 Normative references

IEC 62841-1:2014, Clause 2 and IEC 62841-1:2014/AMD1:2025, Clause 2 are applicable, except as follows.

Replacement:

ISO 3744:2025, *Acoustics - Determination of sound power levels of noise sources using sound pressure - Engineering methods for an essentially free field over a reflecting plane but the listed edition applies*

IEC 60664-1:2020, *Insulation coordination for equipment within low-voltage systems - Part 1: Principles, requirements and tests*

ISO 11201:2010, *Acoustics - Noise emitted by machinery and equipment - Determination of emission sound pressure levels at a work station and at other specified positions in an essentially free field over a reflecting plane with negligible environmental corrections*

Addition:

IEC 60112:2020, *Method for the determination of the proof and the comparative tracking indices of solid insulating materials*¹

IEC 60664-3:2016, *Insulation coordination for equipment within low-voltage systems - Part 3: Use of coating, potting or moulding for protection against pollution*

IEC 60664-4:2005, *Insulation coordination for equipment within low-voltage systems - Part 4: Consideration of high-frequency voltage stress*

IEC 62841-1:2014, *Electric motor-operated hand-held tools, transportable tools and lawn and garden machinery - Safety - Part 1: General requirements*
IEC 62841-1:2014/AMD1:2025

ISO 354:2003, *Acoustics - Measurement of sound absorption in a reverberation room*

ISO 683-4:2016, *Heat-treatable steels, alloy steels and free-cutting steels - Part 4: Free-cutting steels*

ISO 9773:2024, *Plastics - Determination of burning behaviour of thin flexible vertical specimens in contact with a small flame ignition source*

ISO 22868:2021, *Forestry and gardening machinery - Noise test code for portable hand-held machines with internal combustion engine - Engineering method (Grade 2 accuracy)*

3 Terms and definitions

IEC 62841-1:2014, Clause 3 and IEC 62841-1:2014/AMD1:2025, Clause 3 are applicable, except as follows.

Replacement:

3.43

rated speed

output speed assigned to the machine by the manufacturer

Addition:

3.101

blade-tip circle

path described by the outermost point of the **cutting means** or **cutting accessory** cutting edge as it rotates about its **shaft** axis

Note 101 to entry: See Figure 107 and Figure 112.

3.102

cutting accessory

rigid cutting device made of metallic or non-metallic material

¹ This document has been replaced by IEC 60112:2025, *Method for the determination of the proof and the comparative tracking indices of solid insulating materials*.

3.103

cutting element

single freely pivoting non-metallic cutter

3.104

cutting head

support and retention system for the **cutting means**

3.105

cutting means

assembly of freely pivoting non-metallic cutter(s) that rotates about an axis normal to the cutting plane, used to provide the cutting action by one or more **cutting elements**

3.106

debris deflector

additional guarding made of flexible material fitted to the unit as an extension of the **guard** to protect the operator from thrown debris

3.107

depth of cut

vertical location of the **blade-tip circle** relative to the surface level

3.108

edger

grass/soil trimming machine where the **cutting means** or **cutting accessory** operates in a plane approximately perpendicular to the ground

Note 101 to entry: See Figure 101 for an example **hand-held edger**, Figure 102 for an example of a **walk-behind edger**, Figure 103 for an example of a **walk-beside edger**.

3.109

guide handle

front **handle** of a **hand-held** machine by which the operator partially supports the machine

Note 101 to entry: See Figure 101.

3.110

handle

structure that enables the operator to hold and control the unit during operation

3.111

hand-held edger

edger that is supported by hand, possibly assisted by wheel(s) or skids

Note 101 to entry: See Figure 101 for an example of a **hand-held edger**.

3.112

maximum speed

highest output speed attainable under all conditions of **normal use**, including no load

3.113

operator presence sensor

device to detect the presence of an operator's hand

3.114

shaft

structural part of the machine that distances the **cutting means** or **cutting accessory** from the **handles**

3.115

walk-behind edger

edger normally controlled by an operator walking behind the **handle** of a ground-supported machine

Note 101 to entry: See Figure 102 for an example of a **walk-behind edger**.

3.116

walk-beside edger

edger normally controlled by an operator walking beside the **handle** of a ground-supported machine

Note 101 to entry: See Figure 103 for an example of a **walk-beside edger**.

3.117

code protected disabling device

device which, when activated, prevents operation of the machine and requires a coded input (such as via a keypad) before it is deactivated and the machine can operate

Note 301 to entry: See K.21.302.

3.118

removable disabling device

detachable part, such as for example a key, which prevents operation of the machine when it is removed

Note 301 to entry: See K.21.302.

3.119

switched circuit

circuit that is a low-power circuit when the **power switch** is in the "off" position

Note 301 to entry: The requirements for a low-power circuit are given in Annex H.

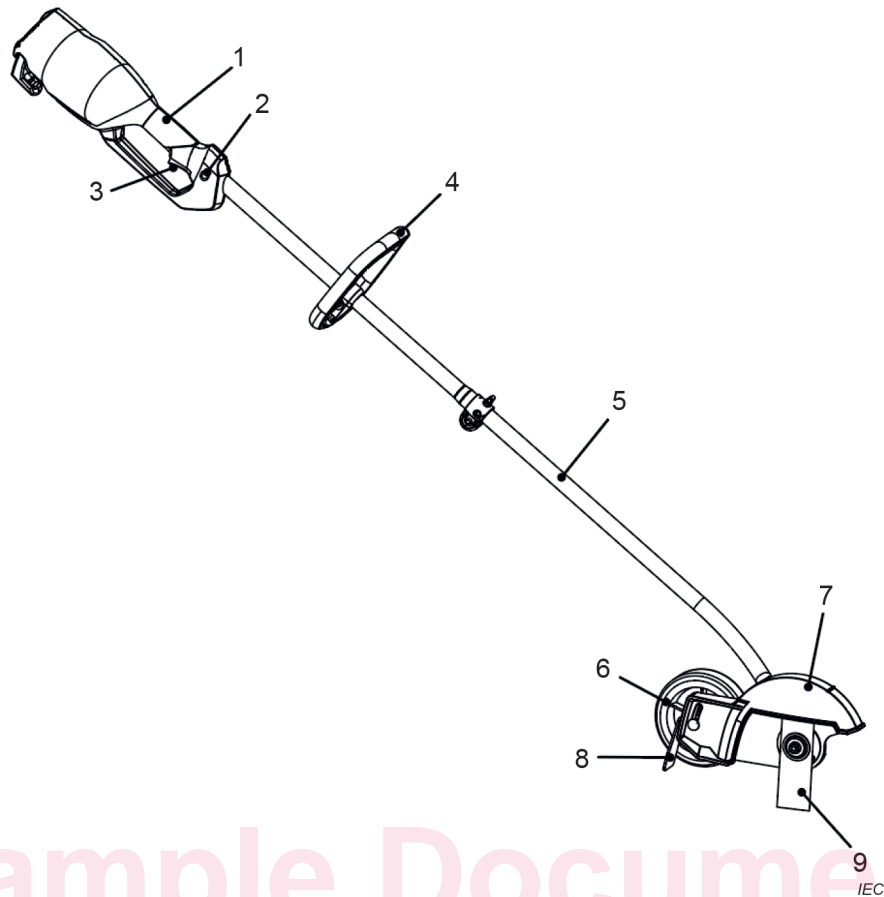

Sample Document

get full document from standards.iteh.ai

Key

- 1 **handle**
- 2 lock-off device
- 3 **power switch**
- 4 **guide handle**
- 5 **shaft**
- 6 support wheel (depth wheel)
- 7 **guard**
- 8 **debris deflector**
- 9 **cutting accessory**

Figure 101 – Example of a hand-held edger

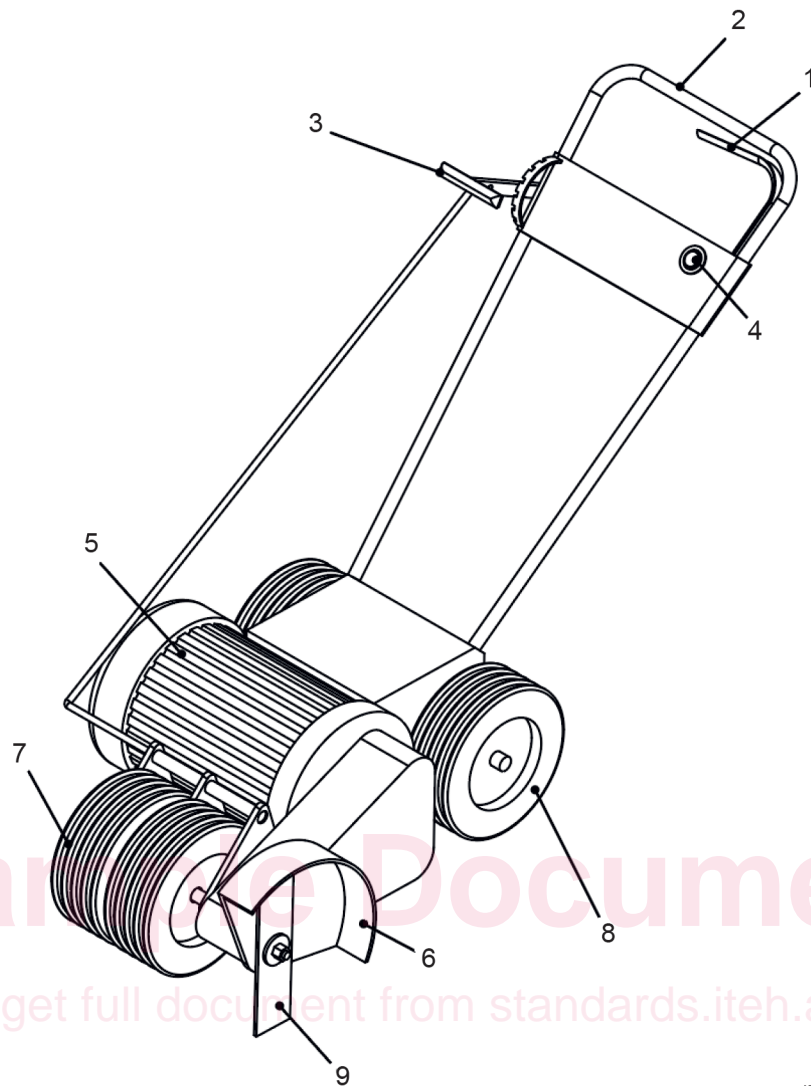

IEC

Key

- 1 **power switch**
- 2 **handle**
- 3 height adjustment
- 4 lock-off device
- 5 motor
- 6 **guard**
- 7 height adjustment wheel
- 8 ground support wheel
- 9 **cutting accessory**

Figure 102 – Example of a walk-behind edger

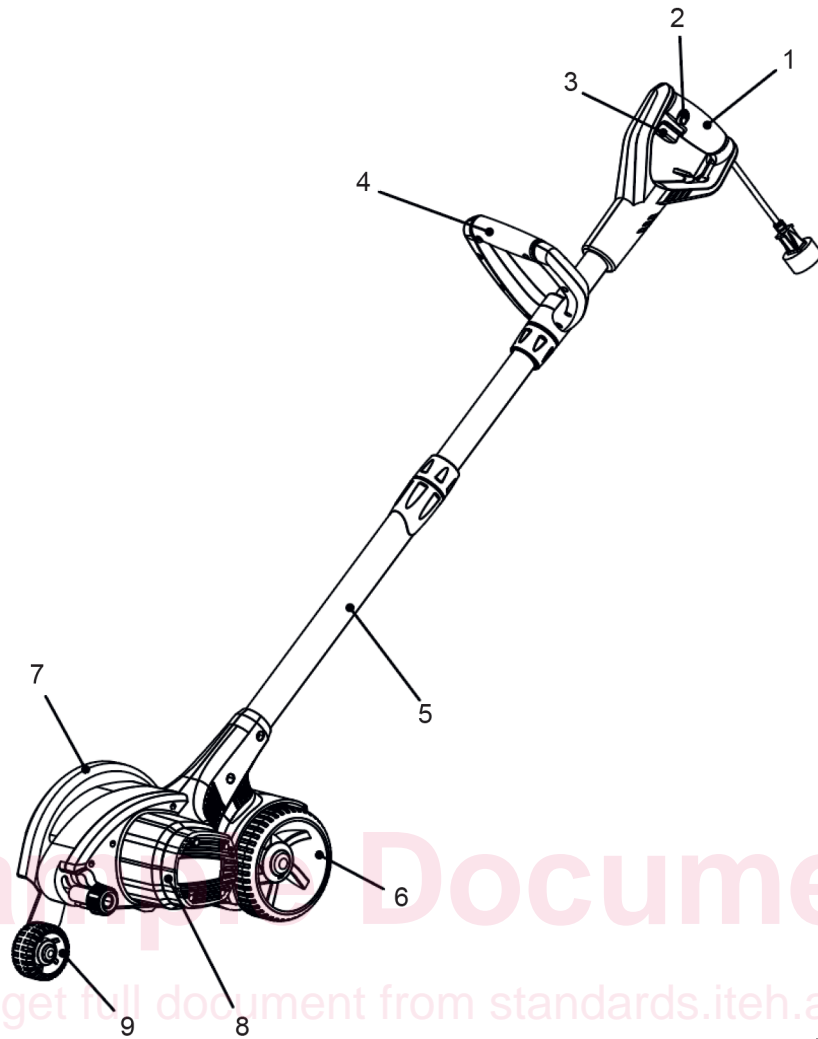

IEC

Key

- 1 **handle**
- 2 lock-off device
- 3 **power switch**
- 4 **guide handle**
- 5 **shaft**
- 6 ground support wheel
- 7 **guard**
- 8 motor
- 9 height adjust wheel

Figure 103 – Example of a walk-beside edger

4 General requirements

IEC 62841-1:2014, Clause 4 is applicable.

5 General conditions for the tests

IEC 62841-1:2014, Clause 5 is applicable, except as follows:

5.4 Addition:

Handle positions that are used for storage or transportation purposes are not included in this requirement.

5.7.2 Replacement:

Machines are tested at **rated voltage**. Machines having more than one **rated voltage** or having a **rated voltage range** are tested at the highest voltage.

5.17 Addition:

For **edgers** with a **cutting accessory**, the mass of the machine includes the heaviest **cutting accessory** in accordance with 8.14.2 a) 104), but excludes the harness and hip pad, if any.

For **edgers** with a **cutting means**, the mass of the machine includes the **cutting head**

- with freely pivoting non-metallic cutters, if any; and
- with a bobbin for non-metallic filament line, if any;
- without the non-metallic filament line, if any;

and for **hand-held edgers**, wheels or skids, if any.

5.101 The tests are carried out on the machine as supplied. However, a machine constructed as a single machine but supplied in an unassembled state is tested after assembly in accordance with 8.14.2.

5.102 Unless otherwise specified, for Clauses 19 and 21, machines are tested in each operating configuration as described in 8.14.2.

5.103 The manufacturer may provide special hardware and/or software for tests that are performed at **maximum speed** and no-load.

6 Radiation, toxicity and similar hazards

IEC 62841-1:2014, Clause 6 is applicable.

7 Classification

IEC 62841-1:2014, Clause 7 is applicable, except as follows:

7.1 Replacement:

Machines shall be a **class II tool** (machine) or **class III tool** (machine).

Compliance is checked by inspection and by the relevant tests.