



SLOVENSKI STANDARD
oSIST prEN 295-3:2026
01-junij-2026

**Keramični (iz vitrificirane gline) cevni sistemi za odvod odpadne vode in
kanalizacijo - 3. del: Preskusne metode**

Vitrified clay pipe systems for drains and sewers - Part 3: Test methods

Steinzeugrohrsysteme für Abwasserleitungen und -kanäle - Teil 3: Prüfverfahren

Systèmes de tuyaux et accessoires en grès vitrifié pour les collecteurs et branchements
d'assainissement - Partie 3: Méthodes d'essai

Ta slovenski standard je istoveten z: prEN 295-3

ICS:

23.040.50	Cevi in fitingi iz drugih materialov	Pipes and fittings of other materials
91.140.80	Drenažni sistemi	Drainage systems
93.030	Zunanji sistemi za odpadno vodo	External sewage systems

oSIST prEN 295-3:2026

en,fr,de

2003-01.Slovenski inštitut za standardizacijo. Razmnoževanje celote ali delov tega standarda ni dovoljeno.

Sample Document

get full document from standards.iteh.ai

EUROPEAN STANDARD
NORME EUROPÉENNE
EUROPÄISCHE NORM

DRAFT
prEN 295-3

April 2026

ICS 23.040.05

Will supersede EN 295-3:2012

English Version

Vitrified clay pipe systems for drains and sewers - Part 3: Test methods

Systèmes de tuyaux et accessoires en grès vitrifié pour
les collecteurs et branchements d'assainissement -
Partie 3: Méthodes d'essai

Steinzeugrohrsysteme für Abwasserleitungen und -
kanäle - Teil 3: Prüfverfahren

This draft European Standard is submitted to CEN members for enquiry. It has been drawn up by the Technical Committee CEN/TC 165.

If this draft becomes a European Standard, CEN members are bound to comply with the CEN/CENELEC Internal Regulations which stipulate the conditions for giving this European Standard the status of a national standard without any alteration.

This draft European Standard was established by CEN in three official versions (English, French, German). A version in any other language made by translation under the responsibility of a CEN member into its own language and notified to the CEN-CENELEC Management Centre has the same status as the official versions.

CEN members are the national standards bodies of Austria, Belgium, Bulgaria, Croatia, Cyprus, Czech Republic, Denmark, Estonia, Finland, France, Germany, Greece, Hungary, Iceland, Ireland, Italy, Latvia, Lithuania, Luxembourg, Malta, Netherlands, Norway, Poland, Portugal, Republic of North Macedonia, Romania, Serbia, Slovakia, Slovenia, Spain, Sweden, Switzerland, Türkiye and United Kingdom.

Recipients of this draft are invited to submit, with their comments, notification of any relevant patent rights of which they are aware and to provide supporting documentation.

Warning : This document is not a European Standard. It is distributed for review and comments. It is subject to change without notice and shall not be referred to as a European Standard.



EUROPEAN COMMITTEE FOR STANDARDIZATION
COMITÉ EUROPÉEN DE NORMALISATION
EUROPÄISCHES KOMITEE FÜR NORMUNG

CEN-CENELEC Management Centre: Rue de la Science 23, B-1040 Brussels

© 2026 CEN All rights of exploitation in any form and by any means reserved
worldwide for CEN national Members.

Ref. No. prEN 295-3:2026 E

Contents	Page
European foreword	5
1 Scope	6
2 Normative references	6
3 Terms and definitions	7
4 Symbols and abbreviations	7
5 Test for squareness of ends	8
5.1 Test of squareness of ends for pipes according to EN 295-1:2013	8
5.2 Test of squareness of ends for pipes according to EN 295-7:2013	9
6 Straightness test	10
7 Crushing strength test	10
7.1 General.....	10
7.1.1 Preconditioning.....	10
7.1.2 Testing machine	11
7.1.3 Loading	11
7.2 Bearers and bearing strips/facings.....	11
7.2.1 Bearers	11
7.2.2 Bearing strips/facings.....	12
7.3 Support system	12
7.3.1 Flexible hose system (for use with any length of pipe, or pipe section not less than 300 mm in length)	12
7.3.2 Common hydraulic manifold system (for use with any length of pipe, or pipe section not less than 300 mm in length)	14
7.3.3 Rigid systems (restricted to use with pipes or pipe sections from 300 mm to 1 100 mm nominal length)	15
7.4 Test load application	15
7.4.1 Plain ended pipes.....	15
7.4.2 Socketted pipes.....	15
7.4.3 Loading	15
7.5 Results and reporting.....	15
7.5.1 Acceptance (proof) tests.....	15
7.5.2 Ultimate tests	15
7.5.3 Disputes.....	15
7.5.4 Test records	15
8 Bending tensile test	16
8.1 Preconditioning.....	16
8.2 Test procedure.....	16
9 Bending moment resistance (BMR) test	18
9.1 General.....	18
9.1.1 Preconditioning.....	18
9.1.2 Testing machine	18
9.1.3 Loading	19
9.1.4 Choice of test method	19

9.2	Four point loading test	19
9.2.1	Test procedure	19
9.2.2	Testing by attributes	19
9.2.3	Testing by variables.....	19
9.3	Three point loading test.....	20
9.3.1	Test procedure	20
9.3.2	Testing by attributes	20
9.3.3	Testing by variables.....	20
10	Bond strength of adhesive.....	21
11	Tests for fatigue strength.....	22
11.1	Preconditioning.....	22
11.2	Test using a pipe or pipe section.....	22
11.3	Test using sawn test specimens.....	22
12	Test for watertightness	23
12.1	General	23
12.2	Pipes and junctions.....	23
12.3	Fittings other than junctions and terminal fittings.....	23
13	Chemical resistance test for pipes and fittings	23
14	Determination of hydraulic roughness	24
15	Abrasion resistance test.....	24
16	Airtightness test.....	26
17	Tests for resistance to high pressure jetting	26
17.1	General	26
17.1.1	Water source	26
17.1.2	Pressure measurement	26
17.1.3	Test temperature.....	26
17.2	Moving jet test.....	26
17.3	Stationary jet test.....	27
17.3.1	General	27
17.3.2	Apparatus	27
17.3.3	Test pieces.....	28
17.3.4	Procedure.....	28
18	Hardness test for polyurethane.....	29
18.1	Test pieces.....	29
18.2	Test method.....	29
19	Tests for material requirements of polypropylene sleeve couplings.....	29
19.1	Melt flow index	29
19.2	Tensile strength and elongation at break.....	29
19.3	Elevated temperature test.....	30
20	Performance test for polypropylene sleeve couplings	30
21	Mechanical test methods for joint assemblies	30
21.1	General	30
21.2	Deflection test.....	31
21.3	Shear resistance test.....	31
21.3.1	Loading arrangements for shear resistance.....	31
21.3.2	Short-term shear resistance test.....	33
21.3.3	Long-term shear resistance test.....	33

prEN 295-3:2026 (E)

22	Continuity of invert test.....	33
22.1	Test methods	33
22.2	Pipes and fittings with top marking.....	34
22.3	Pipes and fittings randomly jointed.....	35
22.3.1	Sampling and dimensions.....	35
22.3.2	Calculations.....	35
22.3.3	Evaluation.....	36
23	Chemical resistance test for joint assemblies	36
23.1	Test solutions	36
23.2	Procedure	36
24	Thermal stability.....	37
24.1	Thermal cycling stability.....	37
24.2	Long-term thermal stability.....	37
25	Creep resistance of rigid fairing materials.....	38
25.1	Deformation.....	38
25.1.1	Test samples	38
25.1.2	Test apparatus	38
25.1.3	Procedure	38
25.2	Indentation.....	38
25.2.1	Test samples	38
25.2.2	Test apparatus	39
25.2.3	Procedure	39
26	Water tightness test for assembled components of manholes and inspection chambers.....	39
27	Compressive strength of jacking pipes	39
27.1	Test methods	39
27.1.1	Testing machine	39
27.1.2	Selection and preparation of specimens	39
27.1.3	Test procedure.....	41
27.1.4	Loading	41
27.2	Calculation of compressive strength.....	41
28	Water absorption.....	41
28.1	Test specimen	41
28.2	Water absorption test	41

European foreword

This document (prEN 295-3:2026) has been prepared by Technical Committee CEN/TC 165 “Waste water engineering”, the secretariat of which is held by DIN.

This document is currently submitted to the CEN Enquiry.

This document will supersede EN 295-3:2012.

This document includes the following significant technical changes:

- a) Clause 15 “abrasion resistance test” was reworded to correct misleading wording;
- b) 24.1 “Thermal cycling stability” was reworded to correct misleading wording;
- c) The dimension of the test specimen in 28.1 “Test specimen” was corrected;
- d) A duration for cooling was added in 28.2 “Water absorption test”;
- e) The document was editorially revised.

The standard series EN 295 “Vitrified clay pipe systems for drains and sewers” consists of the following parts:

- *Part 1: Requirements for pipes, fittings and joints;*
- *Part 2: Evaluation of conformity and sampling;*
- *Part 3: Test methods;*
- *Part 4: Requirements for adaptors, connectors and flexible couplings;*
- *Part 5: Requirements for perforated pipes and fittings;*
- *Part 6: Requirements for components of manholes and inspection chambers;*
- *Part 7: Requirements for pipes and joints for pipe jacking;*
- *Part 8: Requirements for the use of vitrified clay components in the rehabilitation of drainage systems and conditions for the application of methods for rehabilitation in existing drainage systems (currently in preparation);*
- *Part 9: Environmental Product Declarations – Product Category Rules complementary to EN 15804 (currently in preparation).*

This document takes into account the requirements of EN 476.

prEN 295-3:2026 (E)

1 Scope

This document specifies requirements for testing of products manufactured from vitrified clay and other materials specified in the following standards:

- pipes, fittings and joints according to EN 295-1;
- adaptors, connectors and flexible couplings according to EN 295-4;
- perforated pipes and fittings according to EN 295-5;
- components of manholes and inspection chambers according to EN 295-6;
- pipes and joints for pipe jacking according to EN 295-7.

2 Normative references

The following documents are referred to in the text in such a way that some or all of their content constitutes requirements of this document. For dated references, only the edition cited applies. For undated references, the latest edition of the referenced document (including any amendments) applies.

EN 295-1:2013, *Vitrified clay pipe systems for drains and sewers — Part 1: Requirements for pipes, fittings and joints*

EN 295-4:2013, *Vitrified clay pipe systems for drains and sewers — Part 4: Requirements for adaptors, connectors and flexible couplings*

EN 295-5:2013, *Vitrified clay pipe systems for drains and sewers — Part 5: Requirements for perforated pipes and fittings*

EN 295-6:2013, *Vitrified clay pipe systems for drains and sewers — Part 6: Requirements for components of manholes and inspection chambers*

EN 295-7:2013, *Vitrified clay pipe systems for drains and sewers — Part 7: Requirements for pipes and joints for pipe jacking*

EN ISO 527-2:2025, *Plastics — Determination of tensile properties — Part 2: Test conditions for moulding and extrusion plastics (ISO 527-2:2025)*

EN ISO 868, *Plastics and ebonite - Determination of indentation hardness by means of a durometer (Shore hardness) (ISO 868)*

EN ISO 1133 (all parts) *Plastics — Determination of the melt mass-flow rate (MFR) and the melt volume-flow rate (MVR) of thermoplastics (ISO 1133, all parts)*

CEN/TR 14920:2005, *Jetting resistance of drain and sewer pipes - Moving jet test method*

3 Terms and definitions

For the purposes of this European Standard, the relevant terms and definitions specified in EN 295-1:2013, EN 295-4:2013, EN 295-5:2013, EN 295-6:2013 and EN 295-7:2013 apply.

ISO and IEC maintain terminology databases for use in standardization at the following addresses:

- ISO Online browsing platform: available at <https://www.iso.org/obp/>
- IEC Electropedia: available at <https://www.electropedia.org/>

4 Symbols and abbreviations

Symbol	Description
A	Outside diameter of the spigot moulding
a_M	Measurement from inside of pipe barrel to mid point of inside of socket fairing, in millimetres (continuity of invert test).
a_p	Width of top bearer, in millimetres (crushing strength test and bending tensile strength test).
B	Nominal length of external barrel of pipe unobstructed by socket shape and/or jointing configuration, in millimetres (crushing strength test).
B_t	Distance from the outside surface of the spigot moulding to the internal surface of the pipe at one point at which the outside diameter of the spigot moulding (A) was measured, in millimetres (continuity of invert test).
b	Specimen width, in millimetres (fatigue strength test).
C_t	Distance from the outside surface of the spigot moulding to the internal surface of the pipe at the opposite end to B_t of the diameter measured as the outside diameter of the spigot (A), in millimetres (continuity of invert test).
c	Concentration of solution, in moles per litre (chemical resistance tests).
c_i	Factor for the upper (0,4) or lower (0,1) limit of the load (fatigue strength test).
D	Inside diameter of the socket moulding
DN	Nominal size - a numerical designation of size which is a convenient round number equal to or approximately equal to the internal diameter, in millimetres (bending moment resistance test).
D_S	Deviation from straightness
d_1	Barrel internal diameter, in millimetres (bending tensile strength test).
E_t	Distance from the internal surface of the socket moulding to the internal surface of the pipe at one point at which the inside diameter of the socket moulding (D) was measured, in millimetres (continuity of invert test).
F_i	Force for upper and lower limit, in kilonewtons (fatigue strength test).
F_N	Crushing strength, in kilonewtons per metre.
F_t	Distance from the internal surface of the socket moulding to the internal surface of the pipe at the opposite end to E_t , of the diameter measured as the inside of the socket moulding (D), in millimetres (continuity of invert test)

prEN 295-3:2026 (E)

Symbol	Description
G_m	Mean annular gap, in millimetres (continuity of invert test).
IRHD	International Rubber Hardness Degrees of bearing strips/facings, in degrees IRHD (crushing strength test).
k_s	Hydraulic roughness in millimetres
l_4	Centre line distance between supports, in millimetres (fatigue strength test).
L_N	Nominal length of the pipe
L_T	Test length
M	Bending moment resistance, in kilonewton metres (bending moment resistance test).
M_b	Bending moment, in Newton millimetres (bending tensile strength test).
M_p	Mean particle size, in millimetres (abrasion resistance test).
M_1	Test piece mass before treatment, in grammes (chemical resistance test).
M_2	Test piece mass after treatment, in grammes (chemical resistance test).
S	Support span in metres
s_1	Specimen wall thickness, in millimetres (bending tensile test).
S_{min}, S_{max}	Extreme values of difference in invert, in millimetres (continuity of invert test).
S_t	Standard deviation, in millimetres (continuity of invert test).
s_f	Specimen wall thickness, in millimetres (fatigue strength test).
t	Time.
U	Degree of non-uniformity of particles (abrasion resistance test).
W_{15}	Water addition in 15 min, in litres per square metre (watertightness test).
β	Half the depth of a socket fairing, in millimetres (continuity of invert test).
Δa	Measurement of difference in invert levels, in millimetres (continuity of invert test).
Δs	Deviation from squareness in millimetres.
ε	Deformation of rigid fairing materials (creep resistance of rigid fairing materials test).
σ_i, σ_j	Restoring stress at $t = 10^i$ and $t = 10^j$, in N/mm ² (polyurethane relaxation tests).
σ_{bz}	Bending tensile strength, in Newtons per square millimetre (bending tensile strength test).

5 Test for squareness of ends

5.1 Test of squareness of ends for pipes according to EN 295-1:2013

A whole pipe shall be placed horizontally on two supports which have a distance of 75 mm from each end of the barrel for up to and including DN 500 and 100 mm for pipes greater than DN 500.

The deviation from squareness shall be measured as the maximum difference, at either end, between distances from any point on the end of the barrel to a plane rectangular to the line joining the points of support. Any suitable apparatus may be used. An example is given in Figure 1.

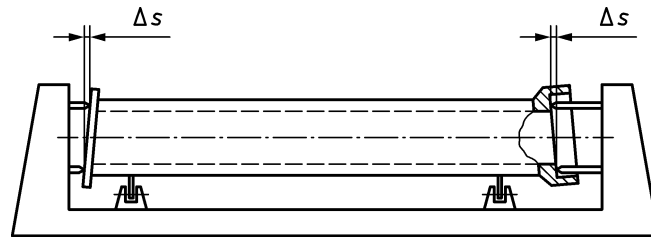
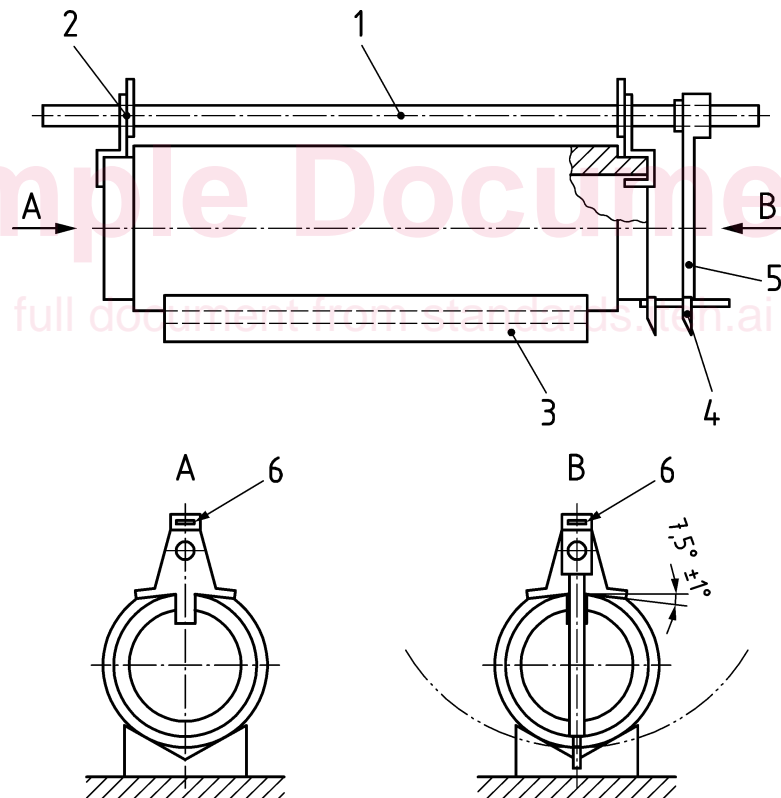

Figure 1 — Measurement of squareness of ends

5.2 Test of squareness of ends for pipes according to EN 295-7:2013

A whole pipe shall be placed on a horizontal support according to Figure 2. The gauge shall be clamped to the ground ends of the pipe. The pivot arm is located approximately 100 mm away from the cut end.

The distance between the pivot arm and the cut end is measured at 90° intervals. The deviation from squareness is the difference between the maximum and minimum measurements. This procedure shall be performed for both ends of the pipe. Any suitable apparatus may be used. An example is given in Figure 2.



Key

- 1 gauge
- 2 clamp
- 3 support
- 4 calliper gauge
- 5 pivot arm
- 6 spirit level

Figure 2 — Gauge for squareness of ends

prEN 295-3:2026 (E)

6 Straightness test

The deviation from straightness of a pipe barrel is the maximum distance from the centre of a straight line equal to the test length spanning any concave curve on the outside of a pipe barrel to the pipe surface, D_s , as shown in Figure 3. It is permissible to test for straightness using any suitable apparatus.

The test length shall be 150 mm less than the nominal length of the pipe to allow for clearance at the shoulder of any socket and at any jointing material at the spigot end.

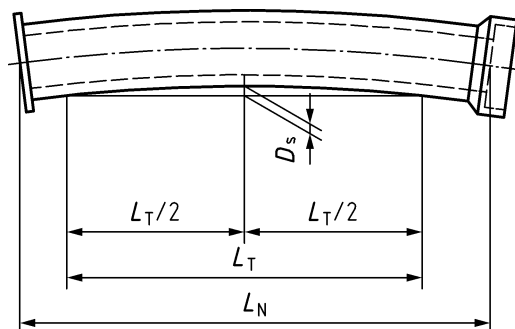

Key

L_N is the nominal length of the pipe

L_T is the test length

D_s is the deviation from straightness

$L_T = L_N - 150$ mm at $DN \leq 500$

$L_T = L_N - 200$ mm at $DN > 500$

Figure 3 — Straightness test method

7 Crushing strength test

7.1 General

7.1.1 Preconditioning

Prior to crushing strength tests, sample pipes or pipe sections shall be preconditioned by either:

- complete immersion in water at ambient temperature for the minimum times given in Table 1, where the wall thickness is the mean wall thickness of the batch,

Table 1 — Preconditioning time for strength tests

Wall thickness mm	Minimum preconditioning time	
	Unglazed, glazed only on interior or exterior surface, salt glazed h	Ceramic glazed h
up to 20	18	42
> 20 to ≤ 35	42	66
> 35	66	90